

## MEM Bath spout for wall mounting - Chrome

MEM

13 801 782



- 220mm projection
- rectangular, air-enriched flow
- rosette 60 x 60 mm
- hole diameter 37 mm
- 1/2" connection
- max. flow 38.5 l/min at 3 bar flow pressure
- WRAS 2203039

|  |                                     |               |
|--|-------------------------------------|---------------|
|  | Chrome                              | 13 801 782-00 |
|  | Brushed Platinum                    | 13 801 782-06 |
|  | Platinum                            | 13 801 782-08 |
|  | Dark Chrome                         | 13 801 782-19 |
|  | Brushed Durabronze<br>(23kt Gold)   | 13 801 782-28 |
|  | Brushed<br>Champagne (22kt<br>Gold) | 13 801 782-46 |
|  | Champagne (22kt<br>Gold)            | 13 801 782-47 |
|  | Brushed Dark<br>Platinum            | 13 801 782-99 |

### Recommended miscellaneous



**Concealed wall elbow -**

35 085 970 90

- max. recess depth 163 mm
- min. recess depth 90 mm



MEM Bath spout for wall mounting - Chrome

MEM

13 801 782

mm [inches]

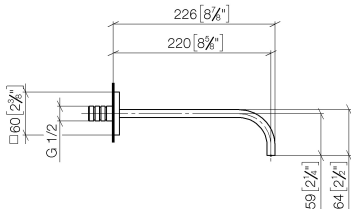

Flow rate chart

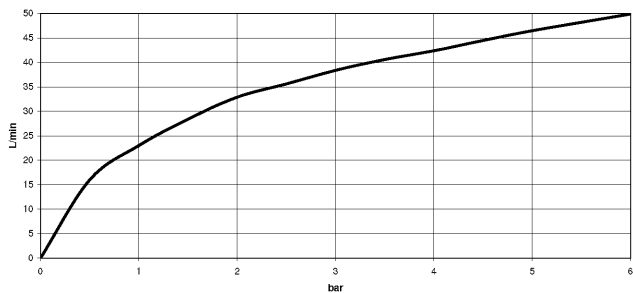

Codes & Standards

ASME A112.18.1

cUPC

Scottish Water  
Byelaws

UK Water Supply  
Regulations



## MEM Bath spout for wall mounting - Chrome

---

MEM

13 801 782

### Certificates

---

WRAS\_2203

IAPMO\_4976

**Product version from 3/10/2014**

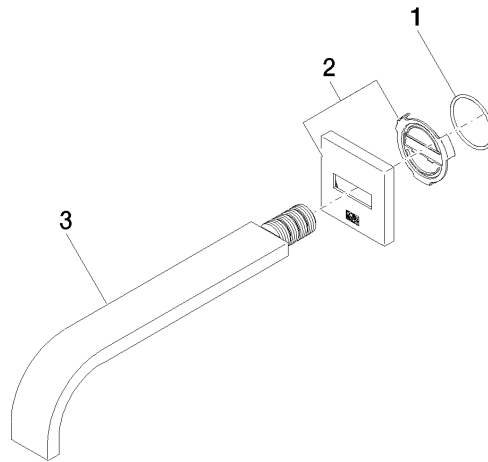



## MEM Bath spout for wall mounting - Chrome

MEM

13 801 782

### Spare parts list

#### Product version from 3/10/2014

| No. | Item Number     | Name | Quantity used | Delivery time |
|-----|-----------------|------|---------------|---------------|
|     | 09 14 10 111 90 | seal | 3             | 2             |