

## Deck valve anti-clockwise closing hot - Brushed Platinum

CL.1

20 000 741



- hole diameter 32 mm
- handle Ø 60mm
- without rosette
- with hot marking
- WRAS 2103001

Fits: CL.1, CYO

	Brushed Platinum	20 000 741-06
	Chrome	20 000 741-00
	Dark Chrome	20 000 741-19
	Brushed Durabronze (23kt Gold)	20 000 741-28
	Matte Black	20 000 741-33
	Brushed Champagne (22kt Gold)	20 000 741-46
	Champagne (22kt Gold)	20 000 741-47
	Brushed Dark Platinum	20 000 741-99

20 000 741

mm [inches]

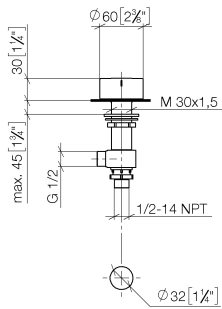

Flow rate chart

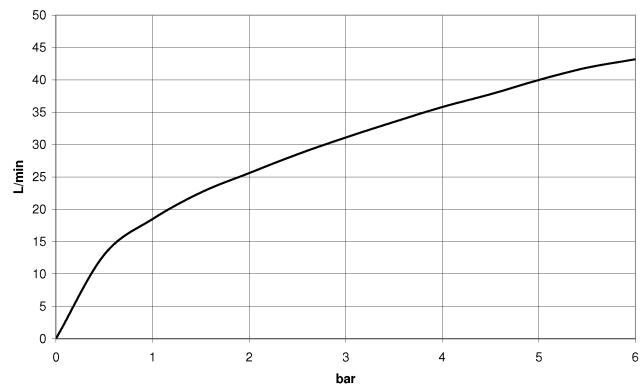

Codes & Standards

ASME A112.18.1	cUPC	DIN 4109	ISO 3822
Scottish Water Byelaws	UK Water Supply Regulations	Ü-Zeichen	



## Deck valve anti-clockwise closing hot - Brushed Platinum

---

CL.1

20 000 741

### Certificates

---

IAPMO\_4976

WRAS\_2103

LGA\_28

20 000 741

**Product version from 4/1/2023**

Parts for other  
finishes can be found  
here: [Chrome](#)

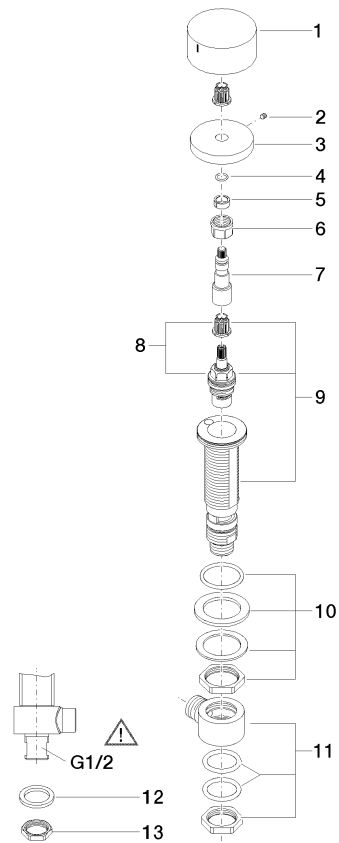



## Deck valve anti-clockwise closing hot - Brushed Platinum

CL.1

20 000 741

### Spare parts list

#### Product version from 4/1/2023

No.	Item Number	Name	Quantity used	Delivery time
	09 20 74 006-06	handle ( hot )	13	10