

META Bath shower set for bath rim or tile edge installation - Brushed Platinum

META

27 632 661 Product version from 7/1/2023



- spout: circular, air-enriched flow
- max. flow 23.5 l/min at 3 bar flow pressure
- Hand shower: COMPACT RAIN, max. flow rate 6.8 l/min (at 3 bar)
- complete hand shower set with anti-scale system
- automatic bath/shower diverter
- 221mm projection
- height of mixer 319 mm
- height up to aerator 216 mm
- hole diameter spout 35 mm
- hole diameter single-lever mixer 35 mm
- hole diameter for complete hand shower set 32 mm
- rosette for spout Ø 60mm
- rosette for single-lever mixer Ø 55mm
- rosette for complete hand shower set Ø 60mm
- metal shower hose 1750mm with integrated anti-twist protection
- WRAS

Intrinsic protection against back flow.

| | | |
|---|-------------------------------|---------------|
|  | Brushed Platinum | 27 632 661-06 |
|  | Chrome | 27 632 661-00 |
|  | Dark Chrome | 27 632 661-19 |
|  | Light Gold | 27 632 661-26 |
|  | Brushed Light Gold | 27 632 661-27 |
|  | Matte Black | 27 632 661-33 |
|  | Brushed Dark Brass | 27 632 661-39 |
|  | Brushed Bronze | 27 632 661-42 |
|  | Brushed Champagne (22kt Gold) | 27 632 661-46 |
|  | Champagne (22kt Gold) | 27 632 661-47 |
|  | Brushed Chrome | 27 632 661-93 |
|  | Brushed Dark Platinum | 27 632 661-99 |

Recommended miscellaneous



Perfecto installation kit -

12 614 970 90

Recommended miscellaneous



**Decorative caps for Perfecto -
Brushed Platinum**

• 1 pair

12 801 970-06

27 632 661 Product version from 7/1/2023

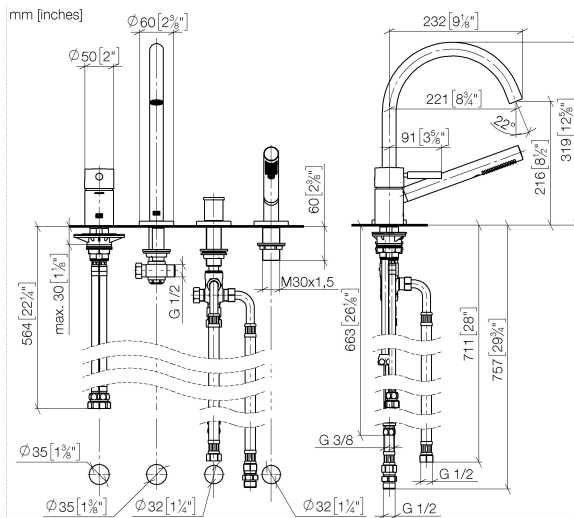

Flow rate chart

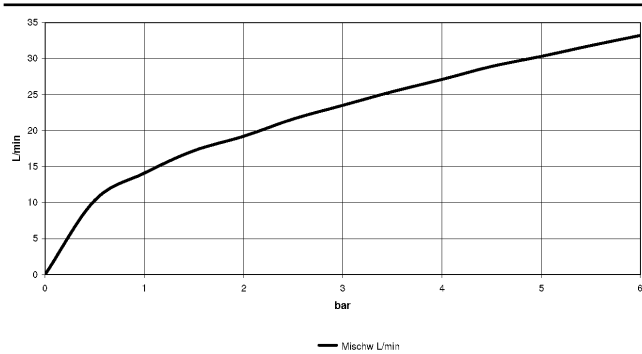

Codes & Standards

| | | | |
|----------------|------------------------|-----------------------------|-----------|
| ASME A112.18.1 | cUPC | DIN 4109 | EN 1717 |
| ISO 3822 | Scottish Water Byelaws | UK Water Supply Regulations | Ü-Zeichen |



META Bath shower set for bath rim or tile edge installation - Brushed Platinum

META

27 632 661 Product version from 7/1/2023

Certificates and sustainability

| | | | |
|--------|-----------|------------|-------------------|
| LGA_38 | WRAS_2207 | IAPMO_4976 | Belgaqua_21-026-2 |
|--------|-----------|------------|-------------------|

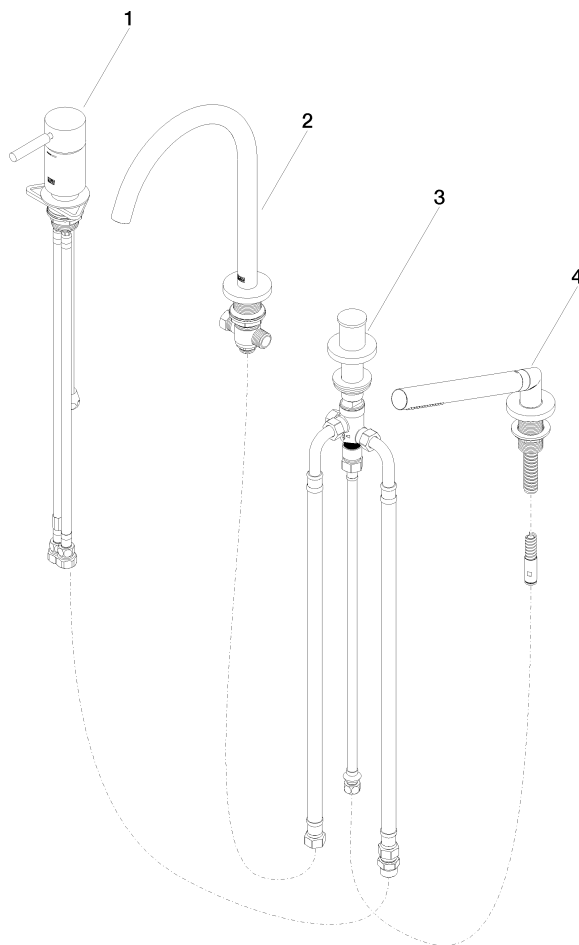

Spare parts list

| No. | Item Number | Name | Quantity used | Delivery time |
|-----|---------------|--|---------------|---------------|
| 2 | 13 512 661-06 | spout | 1.00 | 60 |
| 4 | 27 702 660-06 | META Hand shower set for bath rim or tile edge installation - Brushed Platinum | 1.00 | 10 |
| 3 | 29 140 660-06 | META Two-way diverter for bath rim or tile edge installation - Brushed Platinum | 1.00 | 10 |
| 1 | 29 300 660-06 | META Single-lever bath mixer for bath rim or tile edge installation - Brushed Platinum | 1.00 | 10 |