

## VAIA Bath shower set for bath rim or tile edge installation - Brushed Dark Platinum

VAIA

27 632 809



- spout: circular, air-enriched flow
- max. flow 24.6 l/min at 3 bar flow pressure
- Hand shower: COMPACT RAIN, max. flow rate 6.8 l/min (at 3 bar)
- complete hand shower set with anti-scale system
- automatic bath/shower diverter
- 220mm projection
- height of mixer 347 mm
- height up to aerator 244 mm
- hole diameter spout 32 mm
- hole diameter single-lever mixer 35 mm
- hole diameter for complete hand shower set 32 mm
- rosette for spout Ø 60mm
- rosette for single-lever mixer Ø 55mm
- rosette for complete hand shower set Ø 60mm
- metal shower hose 1750mm with integrated anti-twist protection

Intrinsic protection against back flow.

	Brushed Dark Platinum	27 632 809-99
	Chrome	27 632 809-00
	Brushed Platinum	27 632 809-06
	Platinum	27 632 809-08
	Dark Chrome	27 632 809-19
	Brushed Durabronze (23kt Gold)	27 632 809-28
	Brushed Bronze	27 632 809-42
	Brushed Champagne (22kt Gold)	27 632 809-46
	Champagne (22kt Gold)	27 632 809-47

### Recommended miscellaneous



**Perfecto installation kit -**

12 614 970 90

### Recommended miscellaneous



**Decorative caps for Perfecto -  
Brushed Dark Platinum**

• 1 pair

12 801 970-99

VAIA Bath shower set for bath rim or tile edge installation - Brushed Dark Platinum

VAIA

27 632 809  
mm [inches]  
1:10

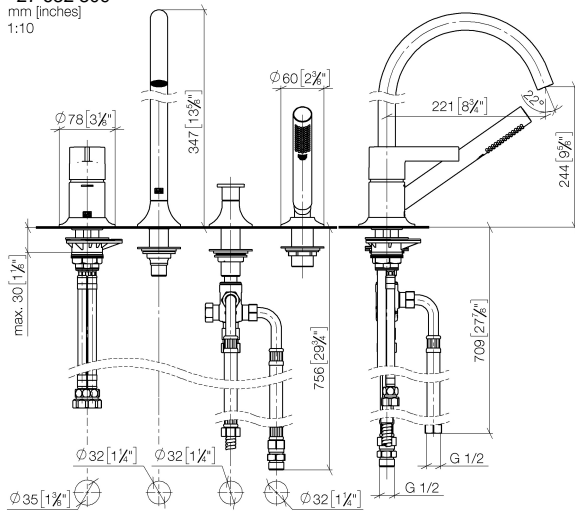

### Flow rate chart

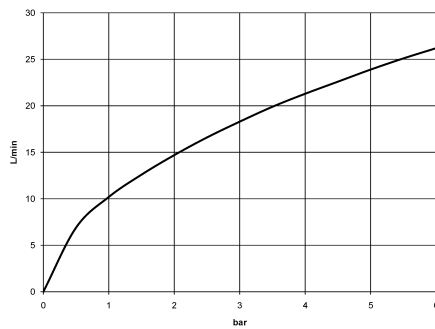

## Codes & Standards

ASME A112.18.1

cUPC

DIN 4109

EN 1717

ISO 3822

## Ü-Zeichen



## VAIA Bath shower set for bath rim or tile edge installation - Brushed Dark Platinum

VAIA

---

27 632 809

Certificates

---

LGA\_29

Belgaqua\_21-026-2 IAPMO\_4976

**VAIA Bath shower set for bath rim or tile edge installation - Brushed Dark Platinum**

VAIA

27 632 809

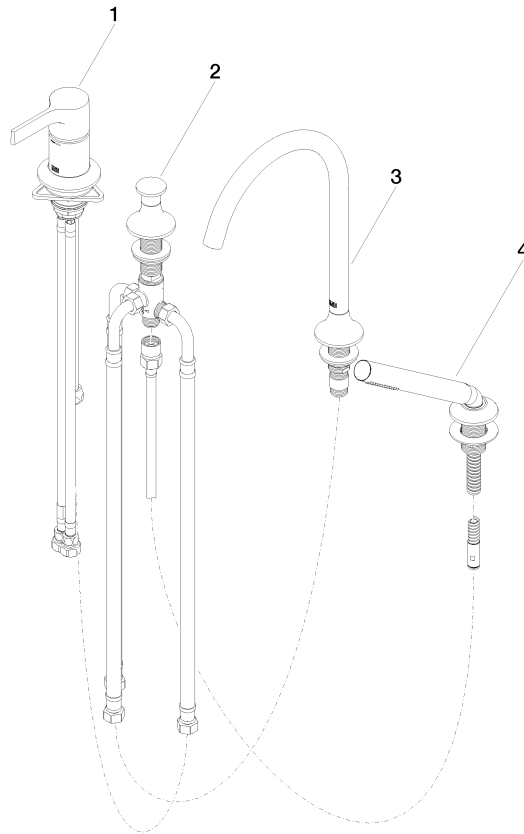



## VAIA Bath shower set for bath rim or tile edge installation - Brushed Dark Platinum

VAIA

27 632 809

### Spare parts list

No.	Item Number	Name	Quantity used	Delivery time
	29 300 809-99	connection	4	30