

## Concealed single-lever mixer with integrated shower connection with shower set without hand shower - Champagne (22kt Gold)

IMO

36 111 970











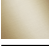

- metal shower hose 1750mm with integrated anti-twist protection
- slide bar
- Pipe diameter 18 mm
- WRAS 2011027

This article does not include a hand shower!

Intrinsic protection against back flow.

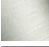
Fits: IMO, LULU, MADISON, MEM, TARA,  
CL.1, LISSÉ, VAIA, META, CYO

|  |                                |               |
|--|--------------------------------|---------------|
|    | Champagne (22kt Gold)          | 36 111 970-47 |
|    | Chrome                         | 36 111 970-00 |
|    | Brushed Platinum               | 36 111 970-06 |
|    | Platinum                       | 36 111 970-08 |
|    | Dark Chrome                    | 36 111 970-19 |
|    | Brushed Light Gold             | 36 111 970-27 |
|    | Brushed Durabronze (23kt Gold) | 36 111 970-28 |
|    | Matte Black                    | 36 111 970-33 |
|    | Brushed Bronze                 | 36 111 970-42 |
|   | Brushed Champagne (22kt Gold)  | 36 111 970-46 |
|  | Brushed Chrome                 | 36 111 970-93 |
|  | Brushed Dark Platinum          | 36 111 970-99 |

**Concealed single-lever mixer with integrated shower connection with shower set without hand shower - Champagne (22kt Gold)**

IMO

36 111 970

mm [inches]

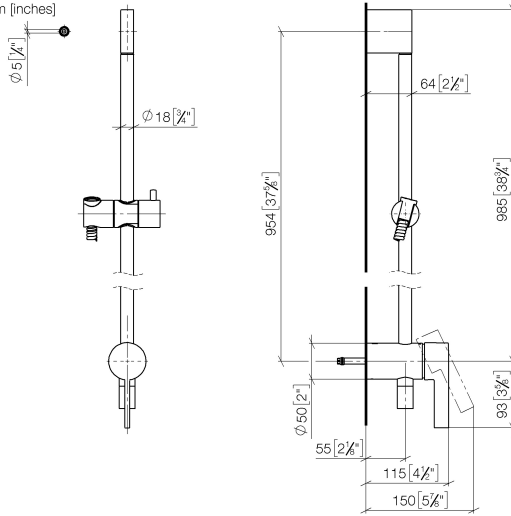

# Concealed single-lever mixer with integrated shower connection with shower set without hand shower - Champagne (22kt Gold)

IMO

36 111 970

**Product version from 10/1/2023**

Parts for other  
finishes can be found  
here: [Chrome](#)

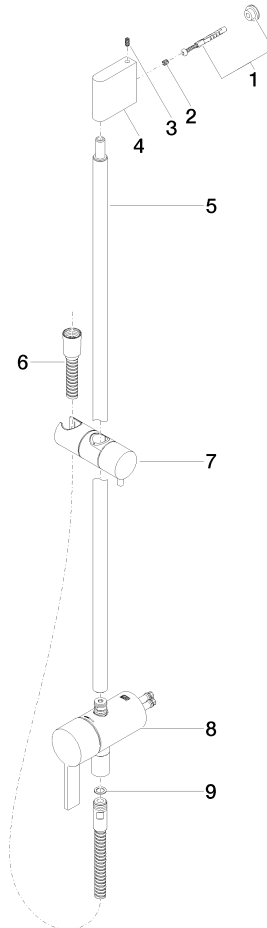



Concealed single-lever mixer with integrated shower connection with shower set without hand shower - Champagne (22kt Gold)

IMO

36 111 970

## Spare parts list

Product version from 10/1/2023

| No. | Item Number        | Name       | Quantity used | Delivery time |
|-----|--------------------|------------|---------------|---------------|
|     | 05 17 20 726 02 90 | fixing set | 11            | 2             |