

## TARA Bath grip - Brushed Champagne (22kt Gold)

TARA

83 030 892



- gauge 300 mm
- width 355mm
- height 55 mm
- rosette Ø 55 mm
- 80mm projection

	Brushed Champagne (22kt Gold)	83 030 892-46
	Chrome	83 030 892-00
	Brushed Platinum	83 030 892-06
	Platinum	83 030 892-08
	Dark Chrome	83 030 892-19
	Brushed Durabronze (23kt Gold)	83 030 892-28
	Matte Black	83 030 892-33
	Brushed Bronze	83 030 892-42
	Champagne (22kt Gold)	83 030 892-47
	Brushed Chrome	83 030 892-93
	Brushed Dark Platinum	83 030 892-99

83 030 892

mm [inches]



**Product version from 4/1/2024**

Parts for other  
finishes can be found  
here: [Chrome](#)

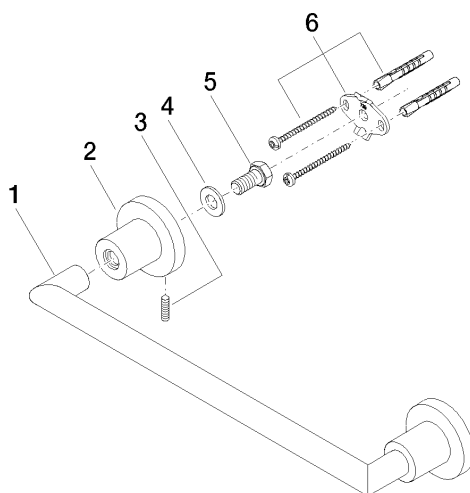



## TARA Bath grip - Brushed Champagne (22kt Gold)

TARA

83 030 892

### Spare parts list

#### Product version from 4/1/2024

No.	Item Number	Name	Quantity used	Delivery time
	05 28 22 587 00-46	holder	11	30