

TARA Bath grip - Brushed Chrome

TARA

83 030 892



- gauge 300 mm
- width 355mm
- height 55 mm
- rosette Ø 55 mm
- 80mm projection

| | | |
|--|--------------------------------|---------------|
|  | Brushed Chrome | 83 030 892-93 |
|  | Chrome | 83 030 892-00 |
|  | Brushed Platinum | 83 030 892-06 |
|  | Platinum | 83 030 892-08 |
|  | Dark Chrome | 83 030 892-19 |
|  | Brushed Durabronze (23kt Gold) | 83 030 892-28 |
|  | Matte Black | 83 030 892-33 |
|  | Brushed Bronze | 83 030 892-42 |
|  | Brushed Champagne (22kt Gold) | 83 030 892-46 |
|  | Champagne (22kt Gold) | 83 030 892-47 |
|  | Brushed Dark Platinum | 83 030 892-99 |

83 030 892

mm [inches]

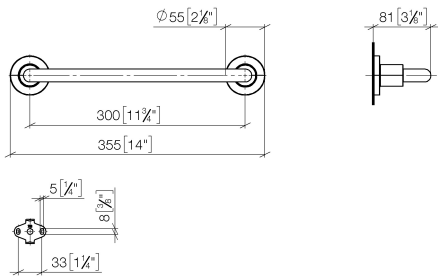

Codes & Standards

TÜV-Zeichen

Certificates

TÜV_B0358530023 TÜV_B0358530023

Product version from 4/1/2024

Parts for other
finishes can be found
here: [Chrome](#)





TARA Bath grip - Brushed Chrome

TARA

83 030 892

Spare parts list

Product version from 4/1/2024

| No. | Item Number | Name | Quantity used | Delivery time |
|-----|--------------------|--------|---------------|---------------|
| | 05 28 22 587 00-93 | holder | 11 | 20 |