

WATER SHEET Cascade spout for wall mounting - Dark Chrome

SERIES-VARIOUS

13 415 979



- 150mm projection
- CASCADE, max. flow rate 26.5 l/min (at 3 bar)
- cover plate 240 x 60 mm
- 1/2" connection
- plug-link mounting
- WRAS

| | | |
|---|-------------------------------------|---------------|
|  | Dark Chrome | 13 415 979-19 |
|  | Chrome | 13 415 979-00 |
|  | Brushed Platinum | 13 415 979-06 |
|  | Platinum | 13 415 979-08 |
|  | Light Gold | 13 415 979-26 |
|  | Brushed Light Gold | 13 415 979-27 |
|  | Brushed Durabronze (23kt Gold) | 13 415 979-28 |
|  | Matte Black | 13 415 979-33 |
|  | Brushed Dark Brass | 13 415 979-39 |
|  | Brushed Bronze | 13 415 979-42 |
|  | Brushed Champagne (22kt Gold) | 13 415 979-46 |
|  | Champagne (22kt Gold) | 13 415 979-47 |
|  | Brushed Chrome | 13 415 979-93 |
|  | Brushed Dark Platinum | 13 415 979-99 |

Recommended miscellaneous



Concealed wall elbow -

- max. recess depth 163 mm
- min. recess depth 90 mm

35 085 970 90

Recommended miscellaneous



Concealed wall elbow -

- max. recess depth 163 mm
- min. recess depth 90 mm

35 085 970 90

13 415 979

mm [inches]

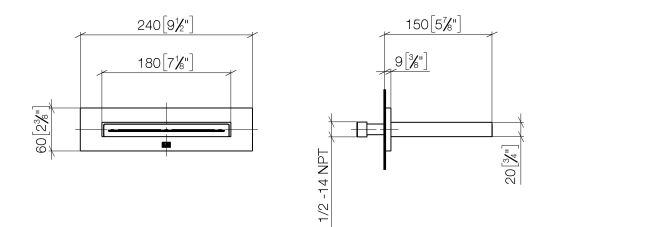

Flow rate chart

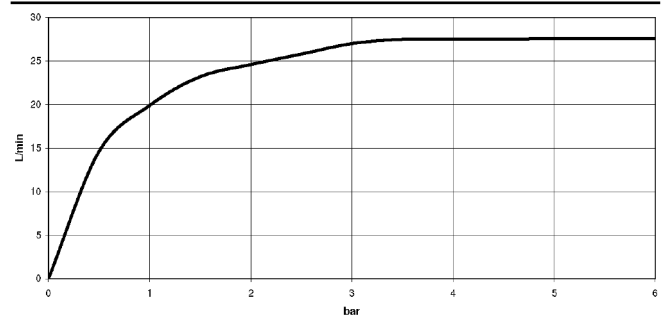

Trajectory diagram

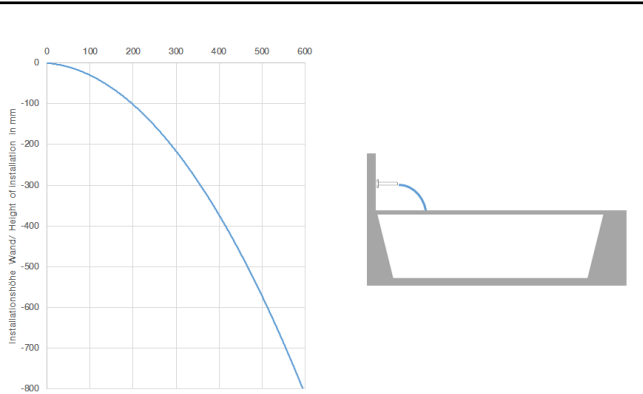

Codes & Standards

| | | | |
|----------------|------|------------------------|-----------------------------|
| ASME A112.18.1 | cUPC | Scottish Water Byelaws | UK Water Supply Regulations |
|----------------|------|------------------------|-----------------------------|



WATER SHEET Cascade spout for wall mounting - Dark Chrome

SERIES-VARIOUS

13 415 979

Certificates and sustainability

WRAS_2306

IAPMO_4976

13 415 979

