

## MEM Three-hole basin mixer with pop-up waste - Dark Chrome

MEM

20 715 782



- 200mm projection
- fixed spout
- rectangular, air-enriched flow
- height of mixer 320 mm
- height up to aerator 195 mm
- hole diameter spout 35 mm
- hole diameter valve 32 mm
- rosette 60 x 60 mm
- 2x screw-in M 10 x 1 pressure hose, leak-tested
- max. flow 8.3 l/min
- lead-free
- This product can help a building meet the requirements of Green Building Rating Systems, e.g. LEED®, BREEAM®, DGNB
- WRAS

Only suitable for basins with an overflow.

|   |                                |               |
|---|--------------------------------|---------------|
|  | Dark Chrome                    | 20 715 782-19 |
|  | Chrome                         | 20 715 782-00 |
|  | Brushed Platinum               | 20 715 782-06 |
|  | Platinum                       | 20 715 782-08 |
|  | Brushed Durabronze (23kt Gold) | 20 715 782-28 |
|  | Brushed Champagne (22kt Gold)  | 20 715 782-46 |
|  | Champagne (22kt Gold)          | 20 715 782-47 |
|  | Brushed Dark Platinum          | 20 715 782-99 |

### Recommended miscellaneous



#### High pressure hoses -

- 2x 3/8" x 1/2" x 500mm high pressure hose

12 506 970 90

20 715 782



**Flow rate chart**



**Codes & Standards**

|                           |                                |                             |            |
|---------------------------|--------------------------------|-----------------------------|------------|
| DIN 4109                  | EN 200                         | Executive Order<br>no. 1007 | ISO 3822   |
| Scottish Water<br>Byelaws | UK Water Supply<br>Regulations | Ü-Zeichen                   | VA-Zeichen |



MEM Three-hole basin mixer with pop-up waste - Dark Chrome

MEM

20 715 782

Certificates and sustainability

|           |        |        |          |
|-----------|--------|--------|----------|
| WRAS_2306 | LGA_18 | ETA_18 | GDV_0400 |
|-----------|--------|--------|----------|

20 715 782

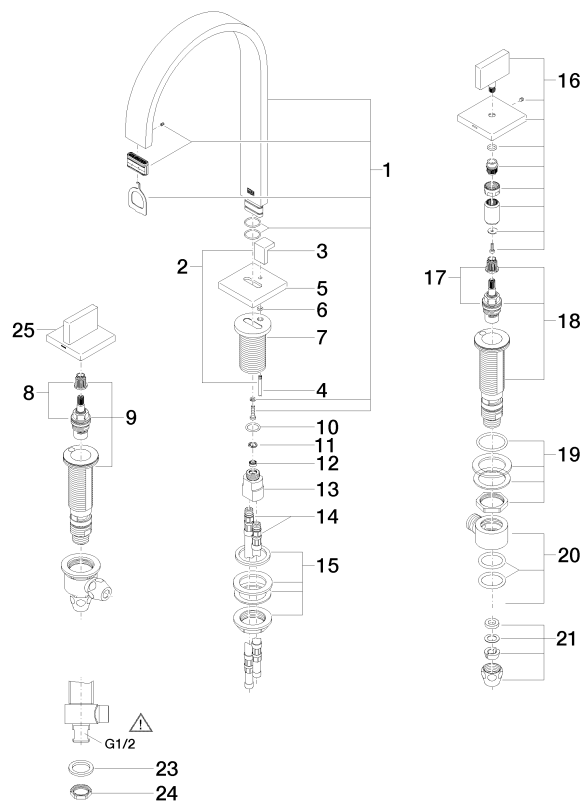

22 ——— Abbildung für 16.11.01.001.00 H