

	<ul style="list-style-type: none"> • spout: circular, air-enriched flow • max. flow 24.6 l/min at 3 bar flow pressure • Hand shower: COMPACT RAIN, max. flow rate 6.8 l/min (at 3 bar) • complete hand shower set with anti-scale system • automatic bath/shower diverter • 220mm projection • height of mixer 347 mm • height up to aerator 244 mm • hole diameter spout 32 mm • hole diameter single-lever mixer 35 mm • hole diameter for complete hand shower set 32 mm • rosette for spout Ø 60mm • rosette for single-lever mixer Ø 55mm • rosette for complete hand shower set Ø 60mm • metal shower hose 1750mm with integrated anti-twist protection 		Brushed Platinum	27 632 809-06
			Chrome	27 632 809-00
			Platinum	27 632 809-08
			Dark Chrome	27 632 809-19
			Brushed Durabrass (23kt Gold)	27 632 809-28
			Brushed Dark Brass	27 632 809-39
			Brushed Bronze	27 632 809-42
			Brushed Champagne (22kt Gold)	27 632 809-46
			Champagne (22kt Gold)	27 632 809-47
			Brushed Dark Platinum	27 632 809-99
Intrinsic protection against back flow.				

Recommended miscellaneous

	Perfecto installation kit -	12 614 970 90
---	------------------------------------	---------------

Recommended miscellaneous

	Decorative caps for Perfecto - Brushed Platinum	12 801 970-06
• 1 pair		

27 632 809 Product version from 4/1/2025

mm [inches]
1:10

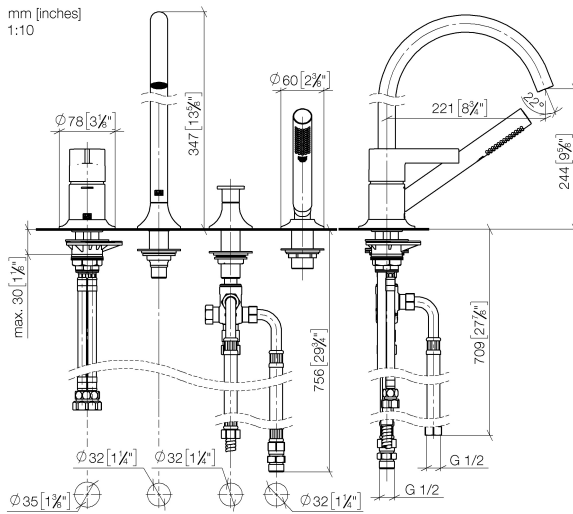

Flow rate chart



Codes & Standards

ASME A112.18.1

cUPC

DIN 4109

EN 1717

ISO 3822

Ü-Zeichen



VAIA Bath shower set for bath rim or tile edge installation - Brushed Platinum

VAIA

27 632 809 Product version from 4/1/2025

Certificates and sustainability

IAPMO_4976 LGA_29 Belgaqua_21-026-2

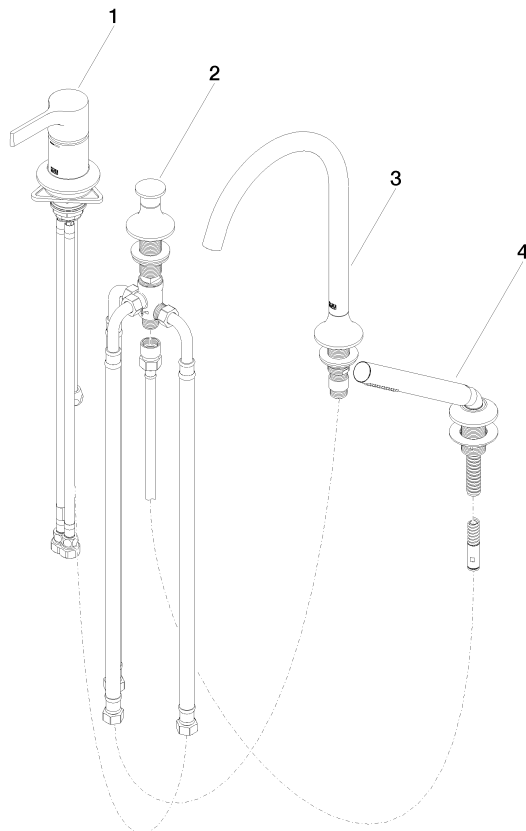

Spare parts list

No.	Item Number	Name	Quantity used	Delivery time
4	27 702 809-06	VAIA Hand shower set for bath rim or tile edge installation - Brushed Platinum	1.00	10
2	29 140 809-06	VAIA Two-way diverter for bath rim or tile edge installation - Brushed Platinum	1.00	10
1	29 300 809-06	connection	1.00	10
3	13 612 809-06	VAIA Bath spout without diverter for deck mounting - Brushed Platinum	1.00	-
Spare part can no longer be ordered, please order the replacement item				