

35 620 970 90



- concealed rough parts
- Rain panel with 3 different flow modes
- AQUACIRCLE RAIN: Circular rain curtain, max. flow rate 12 l/min (at 3 bar)
- TEMPEST RAIN: Natural rain, max. flow rate 10 l/min (at 3 bar)
- Queen's Collar: rounded cascade, max. 24 l/min
- Ceiling installation enclosure 1356 x 1356 x 290 mm
- Opening diameter 1252 mm
- Ceiling construction with adequate structural strength for the permanent attachment of the device (weight: 57.5 kg / 127 lbs. (US)). M8 threaded bolts (minimum strength: 2000 N) are required to secure the ceiling module

Input LED power supply

- Connector, 220-240V AC 50Hz power supply

Output LED power supply

- 12V DC (CV)

Output specification LED power supply

- SELV (Safety Extra Low Voltage)
- Provided by customer: Light switch

Environment

- Not suitable for use in a steam room.
- Not suitable for outdoor use.
- Not suitable for use in chlorinated or salty environments.
- Comply with the protection zone regulations as defined in DIN VDE 0100, Part 701 (IEC 60364-7-701).

Recommended miscellaneous

Leak protection 3/4" -

12 012 970 90

- This article is needed 3x.



35 620 970 90

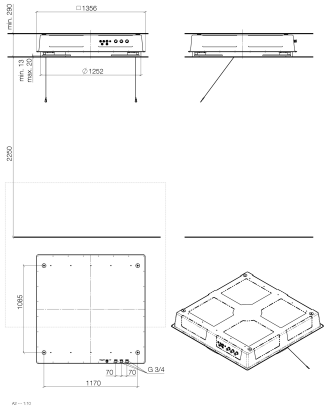

Codes & Standards

DIN 4109

ISO 3822

Ü-Zeichen

Certificates and sustainability

LGA_29

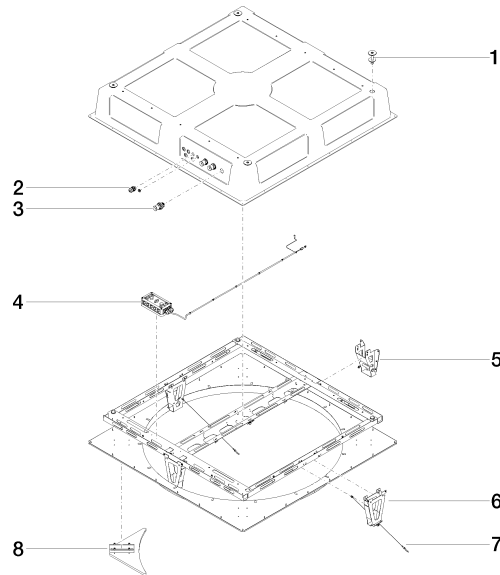

Spare parts list

| No. | Item Number | Name | Quantity used | Delivery time |
|-----|--------------------|------------------------|---------------|---------------|
| 6 | 90 17 20 209 00 90 | holder | 1.00 | 2 |
| 4 | 90 10 01 192 00 90 | electronic accessories | 1.00 | 2 |
| 1 | 04 24 03 239 02 90 | fixing set | 4.00 | 2 |
| 3 | 90 24 03 285 00 90 | connection | 3.00 | 2 |
| 5 | 90 17 20 205 00 90 | holder | 1.00 | 2 |
| 7 | 90 21 50 007 00 90 | accessories | 2.00 | 2 |
| 8 | 90 17 20 215 00 90 | end stop | 4.00 | 2 |
| 2 | 90 10 01 089 00 90 | accessories | 1.00 | 2 |