



- concealed rough parts
- 5x 1/2" female connector
- flush-mounted reflection box, 662 x 482 mm, RAL 9003, Signal White
- min. recess depth 150 mm
- max. recess depth 590 mm
- weight 15kg

## Separate LED power supply

## Input LED power supply

- Electricity supply: 100-240 V AC, 50-60 Hz, 20 W

## Output LED power supply

- 24V DC (CV)

## Output specification LED power supply

- SELV (Safety Extra Low Voltage)
- Class 2

## Ceiling module power supply

- 24V DC (CV)
- Supply pipe 7 m

## Activation

- ZigBee Light Link RGBW controller
- Provided by customer: Zigbee gateway

## Environment

- Not suitable for outdoor use.
- Not suitable for use in a steam room.
- Not suitable for use in chlorinated or salty environments.
- Comply with the protection zone regulations as defined in DIN VDE 0100, Part 701 (IEC 60364-7-701).
- Dornbracht recommends consulting a systems integrator.

## Recommended miscellaneous

### Leak protection 1/2" -

- This article is needed 5x.

12 010 970 90



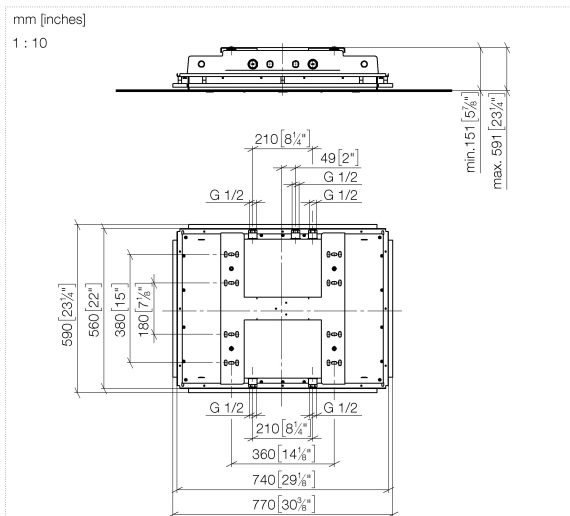

## Codes & Standards

Scottish Water  
Byelaws

UK Water Supply  
Regulations

## Certificates and sustainability

WRAS\_250102

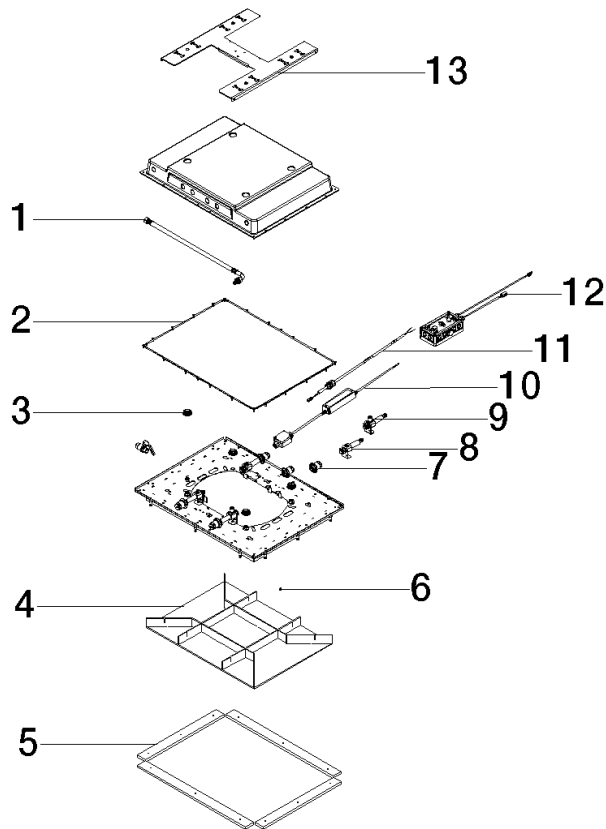

## Spare parts list

| No. | Item Number        | Name                   | Quantity used | Delivery time |
|-----|--------------------|------------------------|---------------|---------------|
| 9   | 90 17 20 308 00 90 | connection             | 2.00          | 2             |
| 10  | 90 10 01 262 00 90 | electronic accessories | 1.00          | 2             |
| 6   | 91 30 30 194 00 90 | screw                  | 1.00          | 2             |
| 3   | 91 31 20 530 00 90 | nipple set             | 1.00          | 2             |
| 2   | 90 14 03 194 00 90 | seal                   | 1.00          | 2             |
| 8   | 90 17 20 308 01 90 | connection             | 3.00          | 2             |
| 4   | 90 91 42 195 01 90 | lid                    | 1.00          | 2             |
| 13  | 90 17 20 304 00 90 | holder                 | 1.00          | 2             |
| 5   | 90 18 30 020 00 90 | sleeve                 | 1.00          | 2             |
| 12  | 90 10 01 264 00 90 | electronic accessories | 1.00          | 2             |
| 11  | 90 10 01 228 00 90 | electronic accessories | 1.00          | 2             |
| 1   | 90 30 04 099 00 90 | hose                   | 1.00          | 2             |
| 7   | 90 24 03 305 00 90 | fixing set             | 5.00          | 2             |