

MEM Wall-mounted basin mixer without pop-up waste - Brushed Platinum

MEM

36 712 782 Product version from 3/10/2014 to 10/27/2020



- 200mm projection
- fixed spout
- rectangular, air-enriched flow
- hole diameter valve 40 mm
- hole diameter spout 40 mm
- individual rosettes 60 x 60 mm
- max. flow 5.7 l/min
- lead-free
- This product can help a building meet the requirements of Green Building Rating Systems, e.g. LEED®, BREEAM®, DGNB
- WRAS

| | | |
|---|--------------------------------|---------------|
|  | Brushed Platinum | 36 712 782-06 |
|  | Chrome | 36 712 782-00 |
|  | Platinum | 36 712 782-08 |
|  | Dark Chrome | 36 712 782-19 |
|  | Brushed Durabronze (23kt Gold) | 36 712 782-28 |
|  | Brushed Champagne (22kt Gold) | 36 712 782-46 |
|  | Champagne (22kt Gold) | 36 712 782-47 |
|  | Brushed Dark Platinum | 36 712 782-99 |

Required miscellaneous



- Concealed wall-mounted mixer centred spout -** 35 700 970 90
- max. recess depth 150 mm
 - min. recess depth 110 mm

Required miscellaneous



- Concealed wall-mounted mixer variable positioning -** 35 720 970 90
- min. recess depth 110 mm
 - max. recess depth 150 mm

36 712 782 Product version from 3/10/2014 to 10/27/2020

mm [inches]



Flow rate chart



Codes & Standards

| | | | |
|--------------------------------|-----------|------------|---------------------------|
| DIN 4109 | EN 200 | ISO 3822 | Scottish Water Byelaws |
| UK Water Supply Regulations | Ü-Zeichen | VA-Zeichen | |



MEM Wall-mounted basin mixer without pop-up waste - Brushed Platinum

MEM

36 712 782 Product version from 3/10/2014 to 10/27/2020

Certificates and sustainability

LGA_18 WRAS_2204 ETA_19

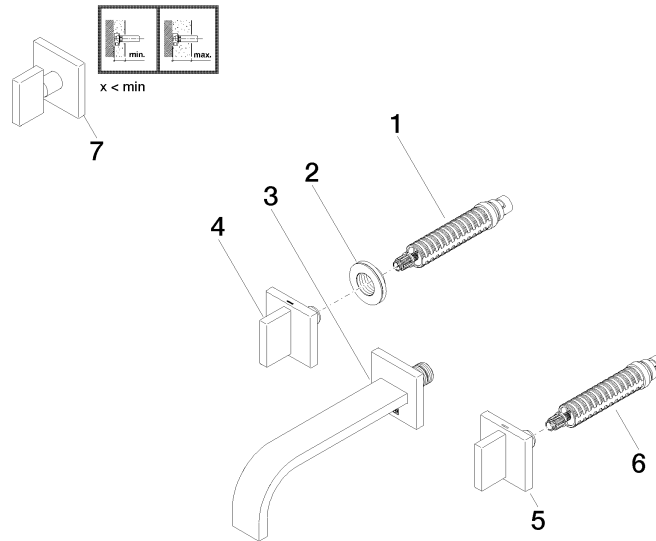

Spare parts list

| No. | Item Number | Name | Quantity used | Delivery time |
|-----|--------------------|--|---------------|---------------|
| 3 | 13 800 782-06 | MEM Wall-mounted basin spout without pop-up waste - Brushed Platinum | 1.00 | 10 |
| 2 | 09 21 02 108 90 | disc | 2.00 | 60 |
| 6 | 90 90 03 157 00 90 | top | 1.00 | 2 |
| 5 | 90 20 78 002 06-06 | handle (cold) | 1.00 | 10 |
| 4 | 90 20 78 002 07-06 | handle (hot) | 1.00 | 10 |
| 1 | 90 90 03 156 00 90 | top | 1.00 | 2 |
| 7 | 90 20 78 002 01-06 | handle | 2.00 | 10 |