

















10 125 970



Passt zu: IMO, LULU, MADISON, MEM,  
TARA, CL.1, LISSÉ, VAIA, META, CYO

|   |   |               |
|---|---|---------------|
|    | Messing gebürstet<br>(23kt Gold)              | 10 125 970-28 |
|    | Chrom   | 10 125 970-00 |
|    | Platin gebürstet                              | 10 125 970-06 |
|    | Platin  | 10 125 970-08 |
|    | Messing (23kt<br>Gold)                        | 10 125 970-09 |
|    | Dark Chrome                                   | 10 125 970-19 |
|    | Light Gold                                    | 10 125 970-26 |
|    | Light Gold<br>gebürstet                       | 10 125 970-27 |
|    | Schwarz matt                                  | 10 125 970-33 |
|   | Platin / Platin<br>gebürstet                  | 10 125 970-36 |
|  | Messing / Messing<br>gebürstet (23kt<br>Gold) | 10 125 970-38 |
|  | Bronze gebürstet                              | 10 125 970-42 |
|  | Champagne<br>gebürstet (22kt<br>Gold)         | 10 125 970-46 |
|  | Champagne (22kt<br>Gold)                      | 10 125 970-47 |
|  | Chrom gebürstet                               | 10 125 970-93 |
|  | Dark Platinum<br>gebürstet                    | 10 125 970-99 |



## Ablaufgarnitur mit Druckverschluss 1 1/4" - Messing gebürstet (23kt Gold)

---

IMO

10 125 970

Nur für Becken mit Überlauf geeignet.

10 125 970

mm [inches]

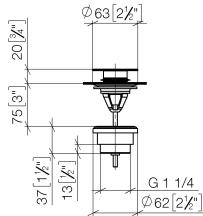

10 125 970

Ersatzteile für die  
anderen  
Oberflächenvarianten  
finden Sie hier:  
Chrom

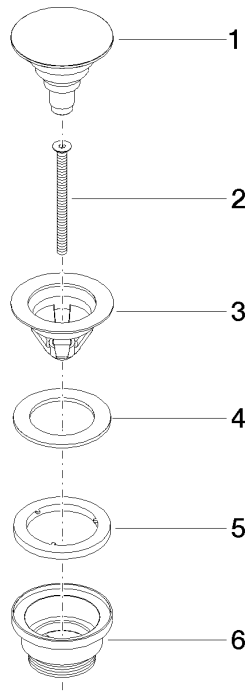

### Ersatzteilstückliste

| Nr. | Artikelnummer      | Benennung | Verbaumenge | Lieferzeit |
|-----|--------------------|-----------|-------------|------------|
| 1   | 04 31 20 096 00-28 | Stopfen   | 1           | 20         |
| 2   | 09 30 30 179 90    | Schraube  | 1           | 2          |
| 3   | 09 11 01 038-28    | Kelch     | 1           | 20         |
| 4   | 09 14 05 061 90    | Dichtung  | 1           | 2          |
| 5   | 09 14 03 153 90    | Dichtung  | 1           | 2          |
| 6   | 09 11 10 156-28    | Anschluss | 1           | 20         |