

## Pop-up waste and overflow with electronic control - Stainless Steel

---

10 410 003 Product version from 4/30/2020



- 3½" electronic drain valve (TouchFlow)
- button integrated in overflow
- concealed overflow
- strainer insert

Only suitable for combining with polished high-grade steel kitchen sinks.

Socket adapter required for 2-pin EU to 3-pin UK plug

### Pop-up waste and overflow with electronic control - Stainless Steel

10 410 003 Product version from 4/30/2020

mm [inches]

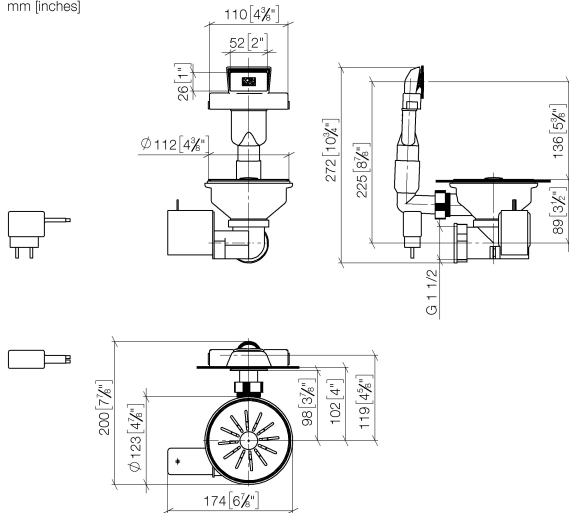

# Pop-up waste and overflow with electronic control - Stainless Steel

10 410 003    Product version from 4/30/2020

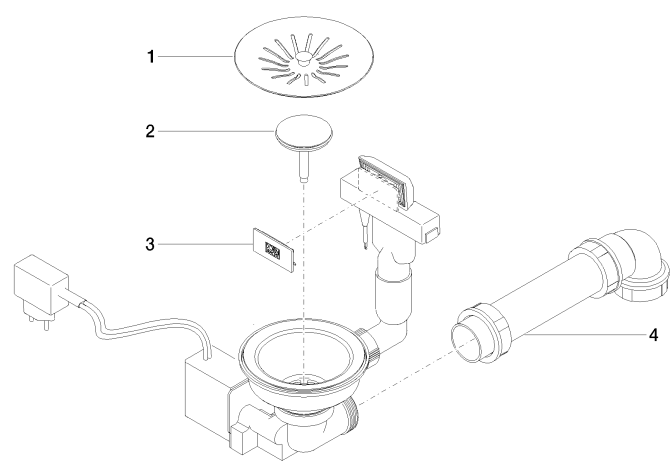

## Spare parts list

No.	Item Number	Name	Quantity used	Delivery time
1	90 11 01 201 06-85	cover	1	60
2	90 11 01 201 01 90	plug	1	60
3	90 11 01 202 00-85	cover	1	60
4	90 11 01 201 02 90	piping	1	60