

## MEM Three-hole basin mixer with pop-up waste - Dark Chrome

MEM

20 713 782



- 165mm projection
- fixed spout
- rectangular, air-enriched flow
- height of mixer 277 mm
- height up to aerator 170 mm
- hole diameter spout 35 mm
- hole diameter valve 32 mm
- rosette 60 x 60 mm
- 2x screw-in M 10 x 1 pressure hose, leak-tested
- max. flow 8.3 l/min
- lead-free
- This product can help a building meet the requirements of Green Building Rating Systems, e.g. LEED®, BREEAM®, DGNB
- WRAS 2306057

Only suitable for basins with an overflow.

	Dark Chrome	20 713 782-19
	Chrome	20 713 782-00
	Brushed Platinum	20 713 782-06
	Platinum	20 713 782-08
	Brushed Durabronze (23kt Gold)	20 713 782-28
	Brushed Champagne (22kt Gold)	20 713 782-46
	Champagne (22kt Gold)	20 713 782-47
	Brushed Dark Platinum	20 713 782-99

20 713 782



**Flow rate chart**



**Codes & Standards**

DIN 4109

EN 200

Executive Order  
no. 1007

ISO 3822

Scottish Water  
Byelaws

UK Water Supply  
Regulations

Ü-Zeichen

VA-Zeichen



## MEM Three-hole basin mixer with pop-up waste - Dark Chrome

MEM

20 713 782

### Certificates

ETA\_18

WRAS\_2306

GDV\_0400

LGA\_18

20 713 782

Parts for other  
finishes can be found  
here: [Chrome](#)

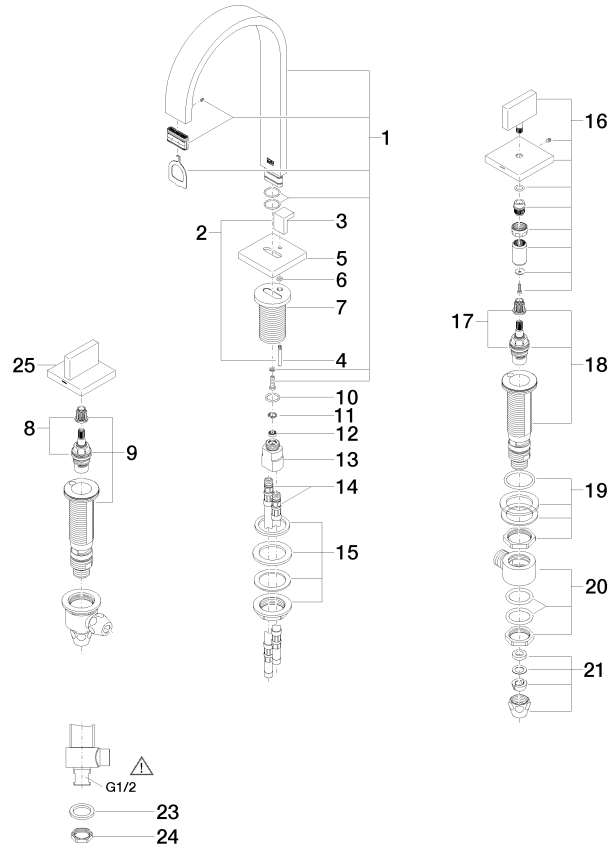



## MEM Three-hole basin mixer with pop-up waste - Dark Chrome

MEM

20 713 782

### Spare parts list