

VAIA Shower set without hand shower - Brushed Dark Platinum

VAIA

26 413 809 Product version from 4/1/2025



- shower hose connector 3/8"
- metal shower hose 1700mm with integrated anti-twist protection
- slide bar

Technical data:

- gauge 800 mm
- rosette Ø 60 mm
- Pipe diameter 18 mm

Notes:

- WRAS

This article does not include a hand shower!

	Brushed Dark Platinum	26 413 809-99
	Chrome	26 413 809-00
	Brushed Platinum	26 413 809-06
	Platinum	26 413 809-08
	Dark Chrome	26 413 809-19
	Brushed Durabronze (23kt Gold)	26 413 809-28
	Brushed Dark Brass	26 413 809-39
	Brushed Bronze	26 413 809-42
	Brushed Champagne (22kt Gold)	26 413 809-46
	Champagne (22kt Gold)	26 413 809-47

VAIA Shower set without hand shower - Brushed Dark Platinum

VAIA

26 413 809 Product version from 4/1/2025

Recommended miscellaneous



Concealed wall elbow -
• max. recess depth 163 mm
• min. recess depth 90 mm

35 085 970 90

Required miscellaneous



**Hand shower - Brushed Dark
Platinum**

28 018 979-99

Recommended miscellaneous



**VAIA Wall elbow - Brushed Dark
Platinum**

28 450 809-99

Required miscellaneous



**Hand shower - Brushed Dark
Platinum**

28 016 979-99

Recommended miscellaneous



**VAIA Wall elbow - Brushed Dark
Platinum**

28 450 809-99

Required miscellaneous



**SERIES-VARIOUS Hand shower
FlowReduce - Brushed Dark
Platinum**

28 025 979-99
0010

Required miscellaneous



**SERIES-VARIOUS Hand shower -
Brushed Dark Platinum**

28 029 979-99

Required miscellaneous



**Hand shower - Brushed Dark
Platinum**

28 012 979-99

Required miscellaneous



**Hand shower FlowReduce -
Brushed Dark Platinum**

28 012 979-99
0010

Required miscellaneous



**Hand shower - Brushed Dark
Platinum**

28 017 979-99

Required miscellaneous



**Hand shower FlowReduce -
Brushed Dark Platinum**

28 016 979-99
0010

Required miscellaneous



**Hand shower FlowReduce -
Brushed Dark Platinum**

28 018 979-99
0010

Required miscellaneous



**SERIES-VARIOUS Hand shower
FlowReduce - Brushed Dark
Platinum**

28 027 979-99
0010

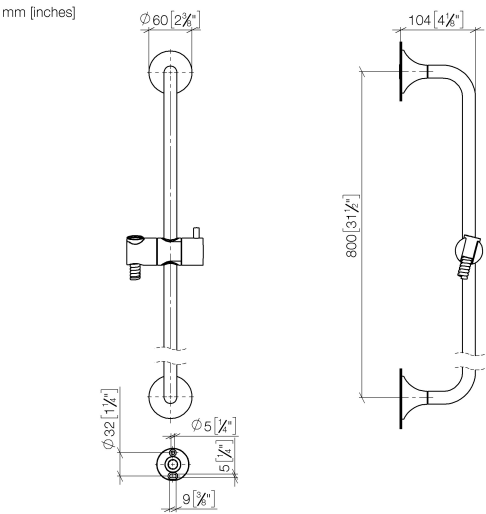

Codes & Standards			
ASME A112.18.1	cUPC	Scottish Water Byelaws	UK Water Supply Regulations
XP P 41-280			

Certificates and sustainability		
WRAS_2009	ACS_20 ACC LY	IAPMO_4976

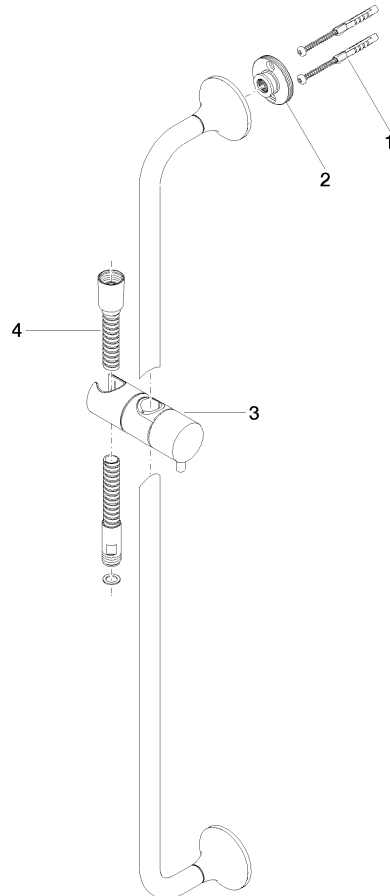

Spare parts list

No.	Item Number	Name	Quantity used	Delivery time
3	12 580 970-99	Slide unit - Brushed Dark Platinum	1.00	20
2	90 17 20 759 00 90	disc	2.00	2
4	28 322 970-99	Metal shower hose 1/2" x 3/8" x 1750 mm - Brushed Dark Platinum	1.00	2
1	05 30 31 025 00 90	fixing set	2.00	2