

## Rain shower for surface-mounted ceiling installation 300 mm - Light Gold

SERIES SPECIFIC

28 031 970 Product version from 5/1/2022



- rain shower Ø 300 mm
- PURE RAIN, max. flow rate 12 l/min (at 3 bar)
- PURIFY RAIN, max. flow rate 6 l/min (at 3 bar)
- with anti-scale system

### Technical data:

- Distance to ceiling from bottom edge of shower 40 mm
- For simultaneous control of the jet types, we recommend the xTool thermostat module
- WRAS

|                                                                                     |                                |               |
|-------------------------------------------------------------------------------------|--------------------------------|---------------|
|    | Light Gold                     | 28 031 970-26 |
|    | Chrome                         | 28 031 970-00 |
|    | Brushed Platinum               | 28 031 970-06 |
|    | Platinum                       | 28 031 970-08 |
|    | Dark Chrome                    | 28 031 970-19 |
|    | Brushed Light Gold             | 28 031 970-27 |
|    | Brushed Durabronze (23kt Gold) | 28 031 970-28 |
|    | Matte Black                    | 28 031 970-33 |
|    | Brushed Dark Brass             | 28 031 970-39 |
|   | Brushed Bronze                 | 28 031 970-42 |
|  | Brushed Champagne (22kt Gold)  | 28 031 970-46 |
|  | Champagne (22kt Gold)          | 28 031 970-47 |
|  | Brushed Chrome                 | 28 031 970-93 |
|  | Brushed Dark Platinum          | 28 031 970-99 |

## Required miscellaneous



### Concealed ceiling installation box 35 041 970 90 with ceiling fixing -

- concealed rough parts
- min. recess depth 90 mm
- max. recess depth 115 mm
- 2x female thread " outlet

mm [inches]

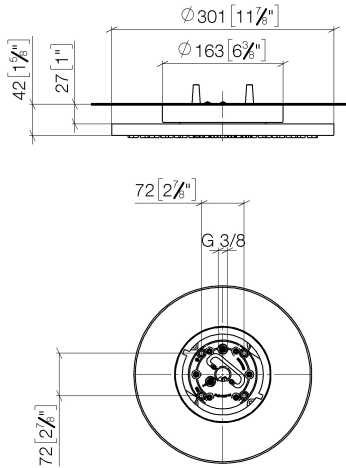

### Flow rate chart



### Codes & Standards

DIN 4109

ISO 3822

Scottish Water  
Byelaws

UK Water Supply  
Regulations

### Ü-Zeichen



## Rain shower for surface-mounted ceiling installation 300 mm - Light Gold

SERIES SPECIFIC

28 031 970 Product version from 5/1/2022

Certificates and sustainability

LGA\_38

WRAS\_240502



Spare parts list

| No. | Item Number        | Name       | Quantity used | Delivery time |
|-----|--------------------|------------|---------------|---------------|
| 1   | 90 17 20 263 00 90 | fixing set | 1.00          | 2             |
| 3   | 90 24 03 309 00 90 | connection | 1.00          | 2             |
| 2   | 90 24 03 309 01 90 | connection | 1.00          | 2             |