

TARA Single-lever mixer - Champagne (22kt Gold)

TARA

33 800 888 Product version from 9/1/2021



- 201mm projection
- pivotable spout 360°
- air-enriched flow
- height of mixer 325 mm
- height up to aerator 180 mm
- hole diameter 35 mm
- max. flow 7 l/min at 3 bar flow pressure
- lead-free
- WRAS
- This product can help a building meet the requirements of Green Building Rating Systems, e.g. LEED®, BREEAM®, DGNB

	Champagne (22kt Gold)	33 800 888-47
	Chrome	33 800 888-00
	Brushed Platinum	33 800 888-06
	Platinum	33 800 888-08
	Durabrass (23kt Gold)	33 800 888-09
	Dark Chrome	33 800 888-19
	Brushed Durabrass (23kt Gold)	33 800 888-28
	Matte Black	33 800 888-33
	Brushed Bronze	33 800 888-42
	Brushed Champagne (22kt Gold)	33 800 888-46
	Brushed Chrome	33 800 888-93
	Brushed Dark Platinum	33 800 888-99

Recommended miscellaneous

**Dispenser with rosette -
Champagne (22kt Gold)**

82 444 970-47



Recommended miscellaneous

**Strainer waste with control handle -
Champagne (22kt Gold)**

10 710 970-47



33 800 888 Product version from 9/1/2021

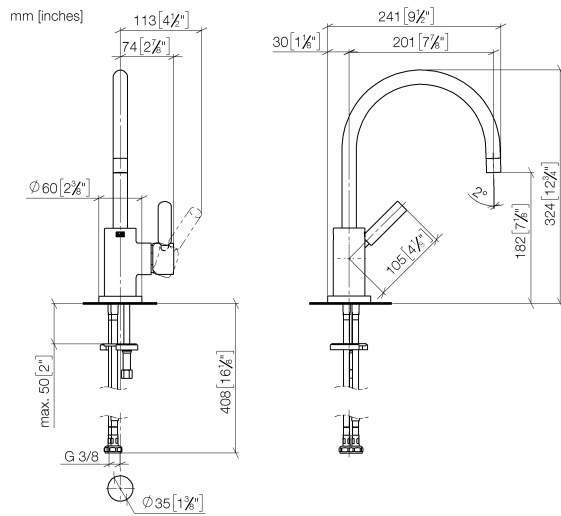

Flow rate chart



Codes & Standards

DIN 4109	EN 817	Executive Order no. 1007	ISO 3822
Scottish Water Byelaws	UK Water Supply Regulations	Ü-Zeichen	VA-Zeichen



TARA Single-lever mixer - Champagne (22kt Gold)

TARA

33 800 888 Product version from 9/1/2021

Certificates and sustainability

GDV_0400	ETA_18	LGA_8	WRAS_2311
----------	--------	-------	-----------

33 800 888 Product version from 9/1/2021

Parts for other
finishes can be found
here: [Chrome](#)

