

EDITION PRO Showerpipe with shower thermostat without hand shower

FlowReduce - Matte Black



EDITION PRO

34 462 626



- shower with fixed riser projection 541mm
- overhead shower: rain flow
- rain shower Ø 300 mm
- rain shower with anti-scale system
- max. rainshower flow 9 l/min
- rotary diverter with volume control and shut-off function
- slide-on rosettes Ø 70 mm
- height of fittings up to rain shower (bottom edge) 1009mm
- height of fittings up to top edge of elbow 1150mm
- gauge 150 mm - 13 mm
- metal shower hose 1750mm with integrated anti-twist protection
- 1/2" connection
- slide bar
- Pipe diameter 23.5 mm
- quick clearing
- This product can help a building meet the requirements of Green Building Rating Systems, e.g. LEED®, BREEAM®, DGNB

This article does not include a hand shower!

	Matte Black	34 462 626-33
	Chrome	34 462 626-00
	Brushed Chrome	34 462 626-93

34 462 626
mm [inches]
1:10

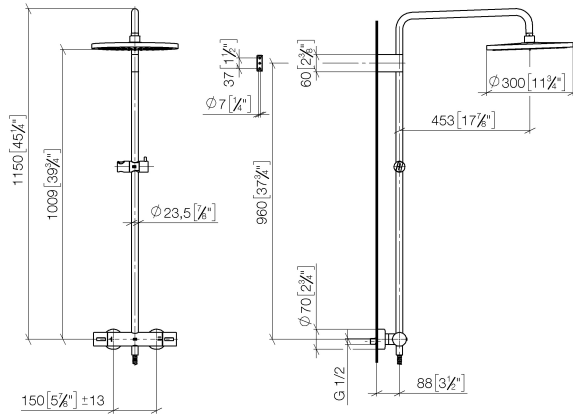

Flow rate chart

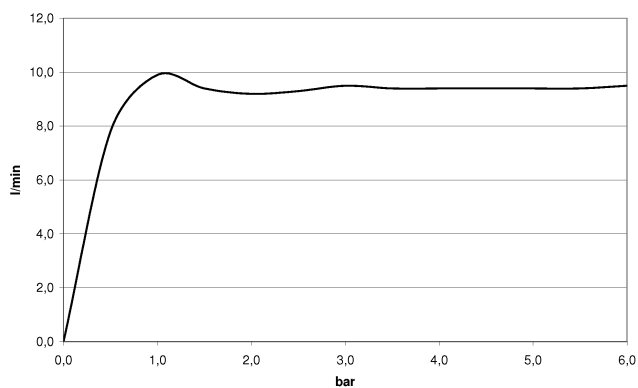

Codes & Standards

DIN 4109

EN 1717

ISO 3822

Ü-Zeichen



EDITION PRO Showerpipe with shower thermostat without hand shower FlowReduce - Matte Black

EDITION PRO

34 462 626

Certificates and sustainability

Belgaqua_24-006-2 LGA_38

34 462 626
Parts for other
finishes can be found
here: [Chrome](#)

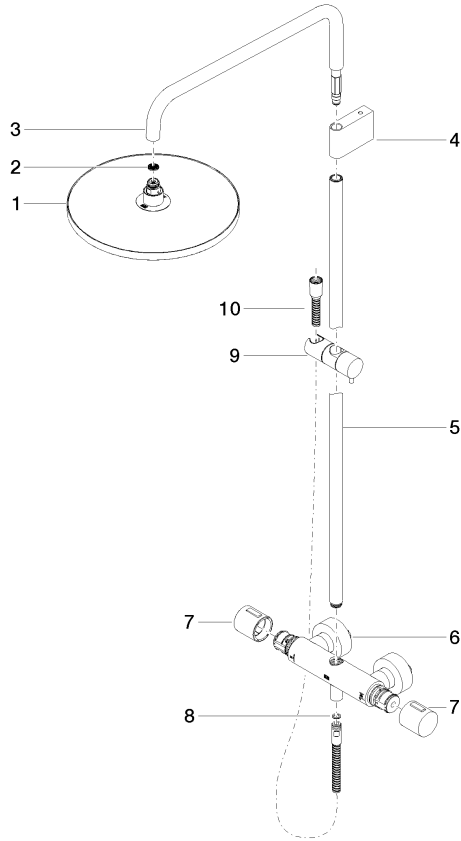

Spare parts list

No.	Item Number	Name	Quantity used	Delivery time
	4 90 17 11 150 00-33	holder	1.00	30
	3 90 28 22 348 00-33	pipe	1.00	30
	6 04 17 01 350 00-33	connection	1.00	30
	5 90 28 22 349 00-33	pipe	1.00	30
	2 09 23 01 039 90	sieve	1.00	2
	9 12 570 970-33	Slide unit - Matte Black	1.00	30
	10 28 322 970-33	Metal shower hose 1/2" x 3/8" x 1750 mm - Matte Black	1.00	2
	1 90 12 05 091 20-33	shower	1.00	30
	7 90 17 33 015 00-33	handle	2.00	30
	8 90 14 20 026 00 90	seal	1.00	2