







CL.1 Concealed two-way diverter - Chrome

36 202 705    Product version from 4/1/2022



- rotary diverter
- rosette 60 x 60 mm
- WRAS

	Chrome	36 202 705-00
	Brushed Platinum	36 202 705-06
	Dark Chrome	36 202 705-19
	Brushed Champagne (22kt Gold)	36 202 705-46
	Champagne (22kt Gold)	36 202 705-47
	Brushed Dark Platinum	36 202 705-99

Required miscellaneous

	<b>Concealed two-way diverter -</b>	35 202 970 90
	•max. recess depth mm	
	•min. recess depth mm	

# CL.1 Concealed two-way diverter - Chrome

36 202 705    Product version from 4/1/2022

mm [inches]

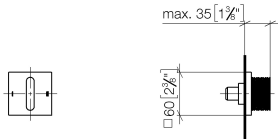

Flow rate chart



## Codes & Standards

DIN 4109	ISO 3822	Scottish Water Byelaws	UK Water Supply Regulations
----------	----------	------------------------	-----------------------------

Ü-Zeichen



## CL.1 Concealed two-way diverter - Chrome

---

36 202 705 Product version from 4/1/2022

### Certificates

---

LGA\_38

WRAS\_2307

# CL.1 Concealed two-way diverter - Chrome

36 202 705    Product version from 4/1/2022

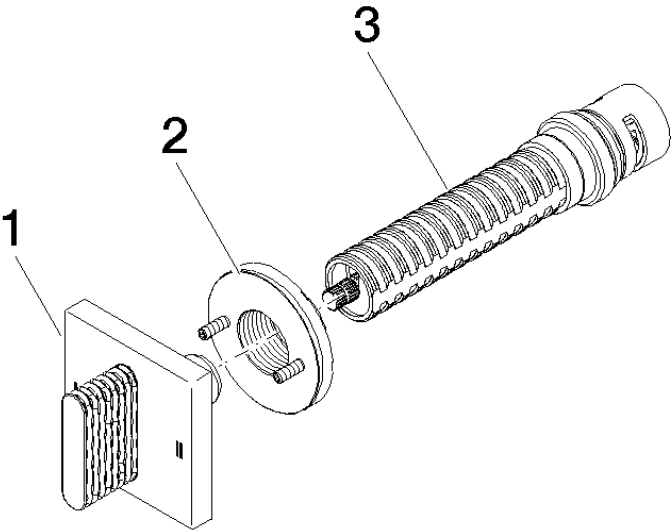

## Spare parts list

No.	Item Number	Name	Quantity used	Delivery time
1	90 20 70 053 08-00	handle	1	10
2	90 21 02 181 00 90	disc	1	2
3	90 90 03 304 10 90	diverter	1	2