

CL.1 Wall valve clockwise closing cold 1/2" - Brushed Champagne (22kt Gold)

CL.1

36 607 706

Product version from 10/14/2020

mm [inches]



Codes & Standards			
ASME A112.18.1	cUPC	DIN 4109	ISO 3822
Scottish Water Byelaws	UK Water Supply Regulations	Ü-Zeichen	

Certificates and sustainability		
LGA_29	WRAS_2010	IAPMO_4976 (

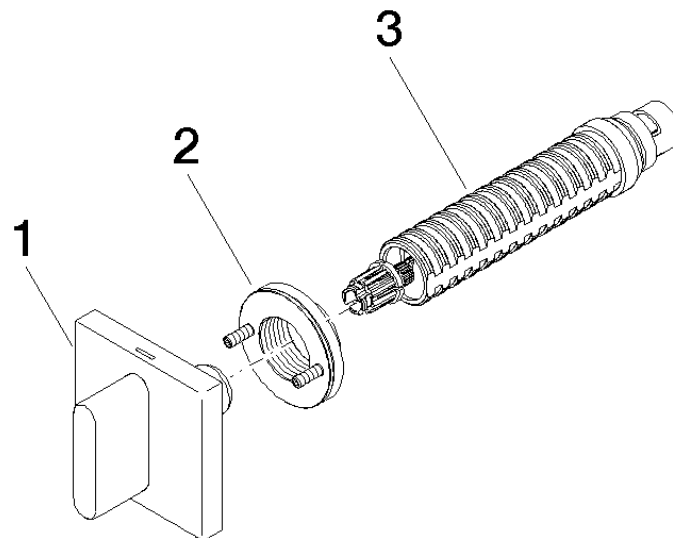

Spare parts list

No.	Item Number	Name	Quantity used	Delivery time
1	90 20 70 051 02-46	handle (cold)	1.00	30
3	90 90 03 143 00 90	top	1.00	2
2	90 21 02 108 00 90	disc	1.00	2