

TARA Bath grip - Brushed Platinum

TARA

83 030 892    Product version from 4/1/2024



- gauge 300 mm
- width 355mm
- height 55 mm
- rosette Ø 55 mm
- 80mm projection

|   |                                  |               |
|---|----------------------------------|---------------|
|    | Brushed Platinum                 | 83 030 892-06 |
|    | Chrome                           | 83 030 892-00 |
|    | Platinum                         | 83 030 892-08 |
|    | Dark Chrome                      | 83 030 892-19 |
|    | Brushed Durabrass<br>(23kt Gold) | 83 030 892-28 |
|    | Matte Black                      | 83 030 892-33 |
|    | Brushed Dark Brass               | 83 030 892-39 |
|    | Brushed Bronze                   | 83 030 892-42 |
|    | Brushed Champagne (22kt Gold)    | 83 030 892-46 |
|   | Champagne (22kt Gold)            | 83 030 892-47 |
|  | Brushed Chrome                   | 83 030 892-93 |
|  | Brushed Dark Platinum            | 83 030 892-99 |

83 030 892 Product version from 4/1/2024

mm [inches]



## Codes & Standards

TÜV-Zeichen

## Certificates and sustainability

TÜV\_B0358530023 TÜV\_B0358530023

83 030 892 Product version from 4/1/2024

Parts for other  
finishes can be found  
here: [Chrome](#)

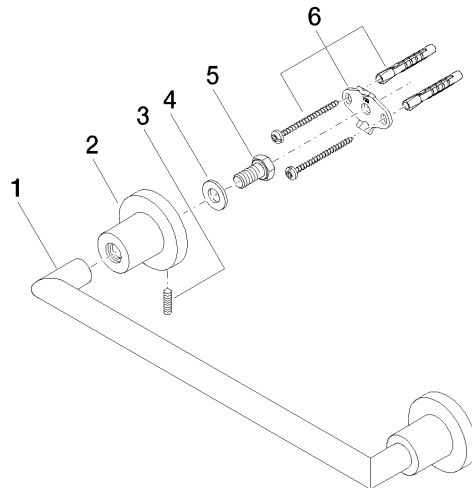

## Spare parts list

| No. | Item Number        | Name       | Quantity used | Delivery time |
|-----|--------------------|------------|---------------|---------------|
| 2   | 08 17 89 505-06    | holder     | 2.00          | 10            |
| 1   | 05 28 22 587 00-06 | holder     | 1.00          | 10            |
| 6   | 05 17 20 739 00 90 | fixing set | 2.00          | 2             |
| 4   | 09 30 11 046 90    | disc       | 2.00          | 2             |
| 3   | 04 31 11 113 00 90 | pin        | 2.00          | 2             |
| 5   | 09 30 30 071 90    | screw      | 2.00          | 2             |