

Towel warmer , 6-fold , projection left , without control element - Brushed Chrome

SERIES SPECIFIC

83 306 980

Product version from 4/1/2025



- gauge 120 mm
- width 600mm
- height 660 mm
- rosette 60 x 60 mm
- 63mm projection
- Degree of protection IP 44, CE marking
- Output per towel bar: 15 watts
- Rated voltage: 220 - 240 V AC

Without control element

Activation must be handled by the customer

Note: Different conditioning.

This appliance is a stationary electric space heater and, in order to comply with the mandatory ecodesign requirements of Commission Regulation (EU) 2024/1103, must be equipped with at least one control with control function TW(f2).

Brushed Chrome

83 306 980-93

Chrome

83 306 980-00

Dark Chrome

83 306 980-19

Matte Black

83 306 980-33

Brushed Champagne (22kt Gold)

83 306 980-46

Brushed Dark Platinum

83 306 980-99

Without control element

Activation must be handled by the customer

Note: Different conditioning.

This appliance is a stationary electric space heater and, in order to comply with the mandatory ecodesign requirements of Commission Regulation (EU) 2024/1103, must be equipped with at least one control with control function TW(f2).

Required miscellaneous



Concealed wall installation box for towel warmer , 6-fold , without control element -

35 313 970 90

- min. recess depth 70 mm
- max. recess depth 105 mm

**Towel warmer , 6-fold , projection left , without control element - Brushed  
Chrome**

SERIES SPECIFIC

83 306 980 Product version from 4/1/2025

mm [inches]

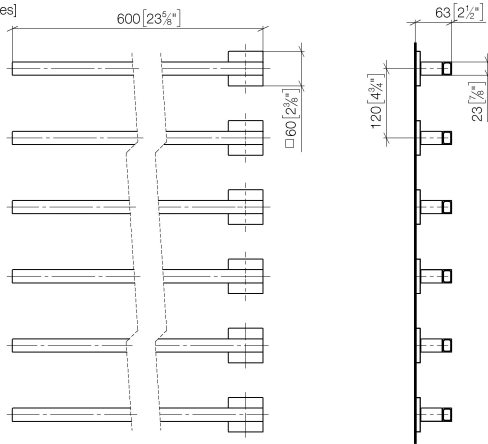

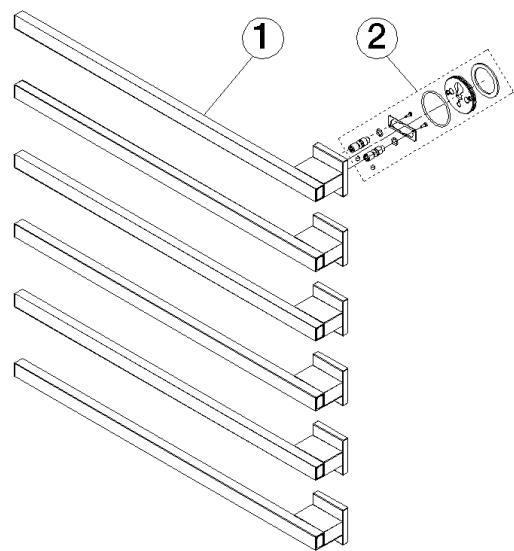

Spare parts list

No.	Item Number	Name	Quantity used	Delivery time
1	90 17 98 561 00-93	holder	1.00	50
2	90 30 30 252 00 90	fixing set	1.00	30