

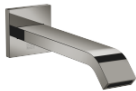





IMO Bath spout for wall mounting - Dark Chrome

IMO

13 801 670    Product version from 4/1/2024

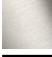

- 200mm projection
- rectangular normal flow
- hole diameter 37 mm
- 1/2" connection
- max. flow 25.1 l/min at 3 bar flow pressure
- WRAS

|   |                       |               |
|---|-----------------------|---------------|
|  | Dark Chrome           | 13 801 670-19 |
|  | Chrome                | 13 801 670-00 |
|  | Brushed Platinum      | 13 801 670-06 |
|  | Brushed Light Gold    | 13 801 670-27 |
|  | Matte Black           | 13 801 670-33 |
|  | Brushed Chrome        | 13 801 670-93 |
|  | Brushed Dark Platinum | 13 801 670-99 |

Recommended miscellaneous

- 

**Concealed wall elbow -**

  - min. recess depth 90 mm
  - max. recess depth 163 mm

35 085 970 90

mm [inches]

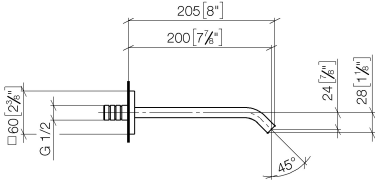

Flow rate chart

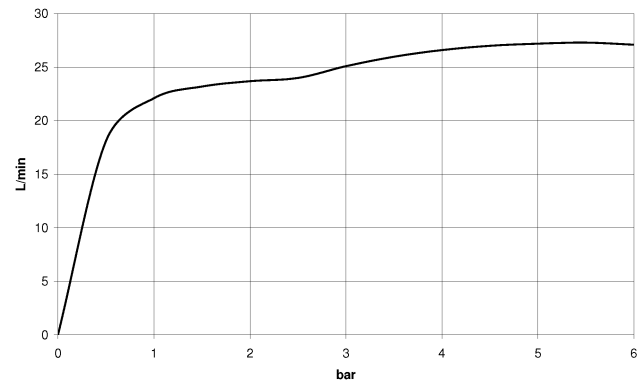

Codes & Standards

|                |      |                        |                             |
|----------------|------|------------------------|-----------------------------|
| ASME A112.18.1 | cUPC | Scottish Water Byelaws | UK Water Supply Regulations |
|----------------|------|------------------------|-----------------------------|



## IMO Bath spout for wall mounting - Dark Chrome

---

IMO

13 801 670 Product version from 4/1/2024

### Certificates and sustainability

---

IAPMO\_4976

WRAS\_2005

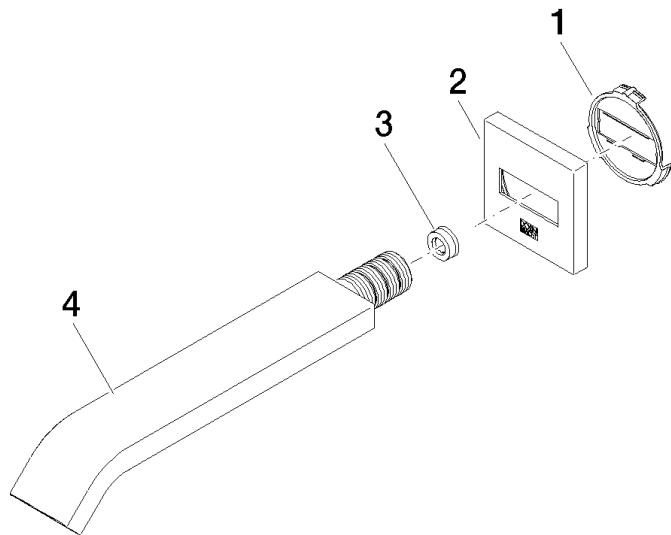

Spare parts list

| No. | Item Number          | Name         | Quantity used | Delivery time |
|-----|----------------------|--------------|---------------|---------------|
|     | 3 09 23 01 057 90    | flow reducer | 1.00          | 2             |
|     | 4 04 28 22 241 00-19 | spout        | 1.00          | 60            |
|     | 1 09 18 40 139 90    | base         | 1.00          | 2             |
|     | 2 09 27 67 008-19    | rosette      | 1.00          | 60            |