

## VAIA Shower set without hand shower - Brushed Dark Platinum

VAIA

26 413 809



- slide bar
- rosette Ø 60 mm
- gauge 800 mm
- metal shower hose 1700mm with integrated anti-twist protection
- shower hose connector 3/8"
- Pipe diameter 18 mm
- WRAS

This article does not include a hand shower!

|  |                                |               |
|--|--------------------------------|---------------|
|   | Brushed Dark Platinum          | 26 413 809-99 |
|   | Chrome                         | 26 413 809-00 |
|   | Brushed Platinum               | 26 413 809-06 |
|   | Platinum                       | 26 413 809-08 |
|   | Dark Chrome                    | 26 413 809-19 |
|   | Brushed Durabronze (23kt Gold) | 26 413 809-28 |
|   | Brushed Bronze                 | 26 413 809-42 |
|   | Brushed Champagne (22kt Gold)  | 26 413 809-46 |
|  | Champagne (22kt Gold)          | 26 413 809-47 |

## VAIA Shower set without hand shower - Brushed Dark Platinum

VAIA

26 413 809

### Recommended miscellaneous

|   |  |               |
|---|--|---------------|
|  | <b>Concealed wall elbow -</b><br>• max. recess depth 163 mm<br>• min. recess depth 90 mm | 35 085 970 90 |
|---|--|---------------|

### Required miscellaneous

|   |  |               |
|---|--|---------------|
|  | <b>Hand shower - Brushed Dark Platinum</b> | 28 018 979-99 |
|---|--|---------------|

### Recommended miscellaneous

|   |  |               |
|---|--|---------------|
|  | <b>VAIA Wall elbow - Brushed Dark Platinum</b> | 28 450 809-99 |
|---|--|---------------|

### Required miscellaneous

|   |  |               |
|---|--|---------------|
|  | <b>Hand shower - Brushed Dark Platinum</b> | 28 016 979-99 |
|---|--|---------------|

### Recommended miscellaneous

|   |  |               |
|---|--|---------------|
|  | <b>VAIA Wall elbow - Brushed Dark Platinum</b> | 28 450 809-99 |
|---|--|---------------|

### Required miscellaneous

|   |  |                    |
|---|--|--------------------|
|  | <b>SERIES-VARIOUS Hand shower FlowReduce - Brushed Dark Platinum</b> | 28 025 979-99 0010 |
|---|--|--------------------|

### Required miscellaneous

|   |   |               |
|---|---|---------------|
|  | <b>SERIES-VARIOUS Hand shower - Brushed Dark Platinum</b> | 28 029 979-99 |
|---|---|---------------|

### Required miscellaneous

|   |  |               |
|---|--|---------------|
|  | <b>Hand shower - Brushed Dark Platinum</b> | 28 012 979-99 |
|---|--|---------------|

### Required miscellaneous

|   |   |                    |
|---|---|--------------------|
|  | <b>Hand shower FlowReduce - Brushed Dark Platinum</b> | 28 012 979-99 0010 |
|---|---|--------------------|

### Required miscellaneous

|   |  |               |
|---|--|---------------|
|  | <b>Hand shower - Brushed Dark Platinum</b> | 28 017 979-99 |
|---|--|---------------|

### Required miscellaneous

|   |   |                    |
|---|---|--------------------|
|  | <b>Hand shower FlowReduce - Brushed Dark Platinum</b> | 28 016 979-99 0010 |
|---|---|--------------------|

### Required miscellaneous

|   |   |                    |
|---|---|--------------------|
|  | <b>Hand shower FlowReduce - Brushed Dark Platinum</b> | 28 018 979-99 0010 |
|---|---|--------------------|

### Required miscellaneous

|   |  |                    |
|---|--|--------------------|
|  | <b>SERIES-VARIOUS Hand shower FlowReduce - Brushed Dark Platinum</b> | 28 027 979-99 0010 |
|---|--|--------------------|

26 413 809

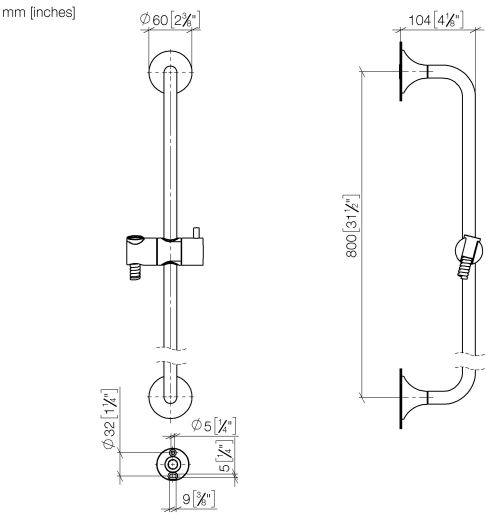

| Codes & Standards |      |                        |                             |
|-------------------|------|------------------------|-----------------------------|
| ASME A112.18.1    | cUPC | Scottish Water Byelaws | UK Water Supply Regulations |
| XP P 41-280       |      |                        |                             |

| Certificates and sustainability |               |            |
|---------------------------------|---------------|------------|
| WRAS_2009                       | ACS_20 ACC LY | IAPMO_4976 |

26 413 809

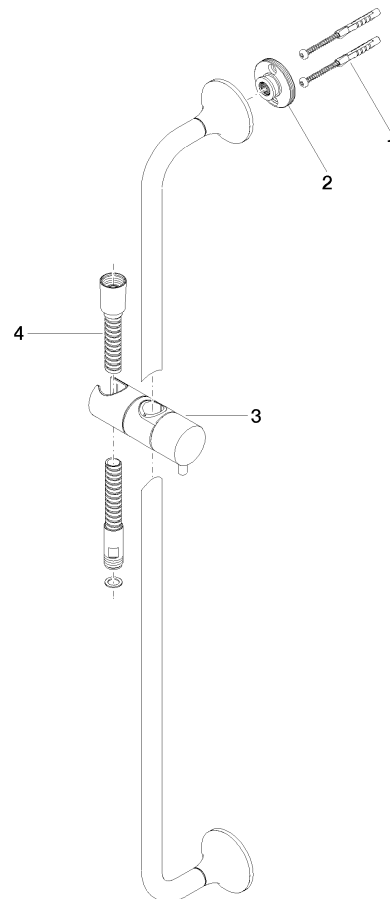

Spare parts list

| No. | Item Number        | Name  | Quantity used | Delivery time |
|-----|--------------------|---|---------------|---------------|
| 3   | 12 580 970-99      | Slide unit - Brushed Dark Platinum                              | 1.00          | 20            |
| 2   | 90 17 20 759 00 90 | disc  | 2.00          | 2             |
| 4   | 28 322 970-99      | Metal shower hose 1/2" x 3/8" x 1750 mm - Brushed Dark Platinum | 1.00          | 2             |
| 1   | 05 30 31 025 00 90 | fixing set  | 2.00          | 2             |