



27 512 710



- spout: circular, air-enriched flow
- max. flow 23.5 l/min at 3 bar flow pressure
- Hand shower: COMPACT RAIN, max. flow rate 6.8 l/min (at 3 bar)
- complete hand shower set with anti-scale system
- 215mm projection
- automatic bath/shower diverter
- height of mixer 110 mm
- height up to aerator 84 mm
- hole diameter valve 32 mm
- hole diameter spout 32 mm
- hole diameter for complete hand shower set 32 mm
- rosette for spout 63 x 63mm
- rosette for complete hand shower set 63 x 63mm
- rosette for deck valve 63 x 63mm
- metal shower hose 1750mm with integrated anti-twist protection

Intrinsic protection against back flow.

	Chrome	27 512 710-00
	Brushed Platinum	27 512 710-06

Recommended miscellaneous



Perfecto installation kit - 12 614 970 90

Recommended miscellaneous



Decorative caps for Perfecto - Chrome 12 801 970-00
● 1 pair



LULU Bath shower set for bath rim or tile edge installation - Chrome

LULU

27 512 710

Certificates

IAPMO_4976

LGA_19

27 512 710

Product version up to 8/31/2015

Product version from 8/31/2015 to 5/15/2020

Product version from 5/15/2020

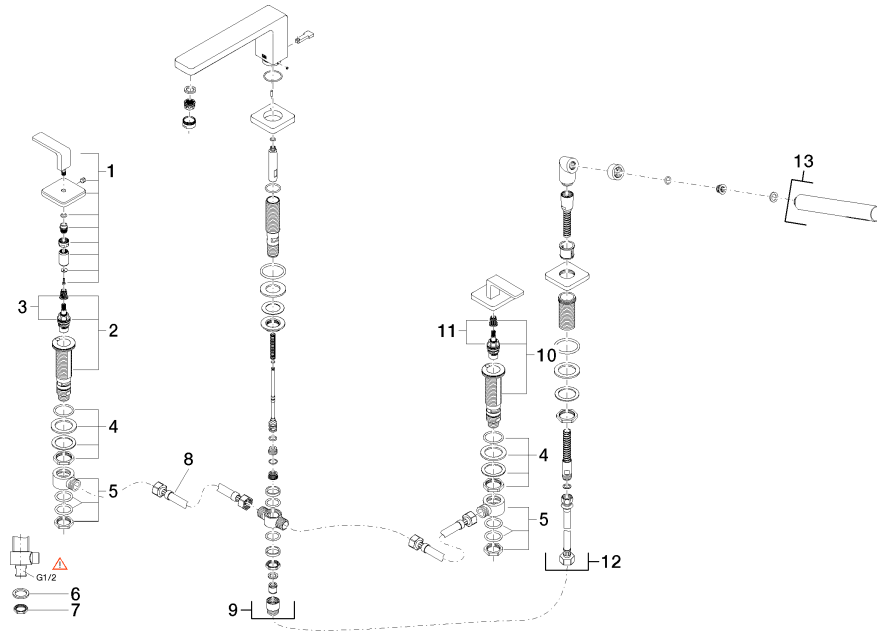



LULU Bath shower set for bath rim or tile edge installation - Chrome

LULU

27 512 710

Spare parts list

Product version up to 8/31/2015

Product version from 8/31/2015 to 5/15/2020

Product version from 5/15/2020

No.	Item Number	Name	Quantity used	Delivery time
	90 20 71 046 00-00	handle	19	10