

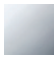

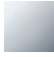







28 508 360



- 200mm projection
- ball-joint pivotable through 30°
- Three settings: PURIFY RAIN, COMPACT SOFT FLOW, COMPACT AQUAPRESSURE FLOW, max. flow rate 7.6 l/min (at 3 bar)
- with anti-scale system
- spray head Ø 94mm
- rosette Ø 55 mm
- 1/2" connection
- This product can help a building meet the requirements of Green Building Rating Systems, e.g. LEED®, BREEAM®, DGNB

|   |                               |                    |
|---|-------------------------------|--------------------|
|    | Chrome                        | 28 508 360-00 0010 |
|    | Chrome                        | 28 508 360-00      |
|    | Brushed Platinum              | 28 508 360-06 0010 |
|    | Brushed Platinum              | 28 508 360-06      |
|    | Platinum                      | 28 508 360-08 0010 |
|    | Platinum                      | 28 508 360-08      |
|    | Durabrand (23kt Gold)         | 28 508 360-09 0010 |
|    | Durabrand (23kt Gold)         | 28 508 360-09      |
|    | Brushed Durabrand (23kt Gold) | 28 508 360-28 0010 |
|   | Brushed Durabrand (23kt Gold) | 28 508 360-28      |
|  | Brushed Dark Platinum         | 28 508 360-99 0010 |
|  | Brushed Dark Platinum         | 28 508 360-99      |

28 508 360

mm [inches]

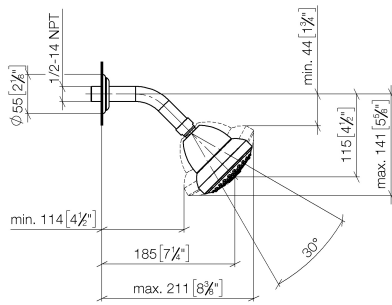

**Flow rate chart**

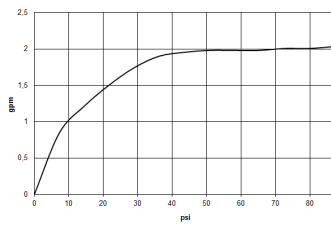

**Certificates**

LGA\_38653.

28 508 360

Parts for other finishes can be found here: [Chrome](#)

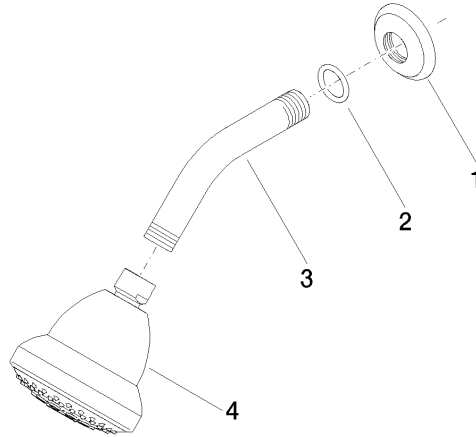

### Spare parts list

| No. | Item Number        | Name       | Quantity used | Delivery time |
|-----|--------------------|------------|---------------|---------------|
| 1   | 09 27 35 003-00    | rosette    | 1             | 10            |
| 2   | 90 14 10 026 00 90 | seal       | 1             | 2             |
| 3   | 09 11 03 011-00    | connection | 1             | 10            |
| 4   | 04 12 11 120 01-00 | shower     | 1             | 10            |