

## Rain shower with ceiling fixing 400 mm - Platinum

SERIES SPECIFIC

28 699 970 Product version from 3/13/2017



- rain shower Ø 400 mm
- PURE RAIN, max. flow rate 20 l/min (at 3 bar)
- Max. flow rate 20 l/min (at 3 bar)
- Function from: 12 l/min
- with anti-scale system
- quick clearing

### Technical dimensions:

- rosette Ø 60 mm optional
- 1/2" connection
- WRAS

Product change as of 1st April 2024: max. flow 20l/min

|   |                                |               |
|---|--------------------------------|---------------|
|    | Platinum                       | 28 699 970-08 |
|    | Chrome                         | 28 699 970-00 |
|    | Brushed Platinum               | 28 699 970-06 |
|    | Dark Chrome                    | 28 699 970-19 |
|    | Light Gold                     | 28 699 970-26 |
|    | Brushed Light Gold             | 28 699 970-27 |
|    | Brushed Durabronze (23kt Gold) | 28 699 970-28 |
|    | Matte Black                    | 28 699 970-33 |
|    | Brushed Bronze                 | 28 699 970-42 |
|   | Brushed Champagne (22kt Gold)  | 28 699 970-46 |
|  | Champagne (22kt Gold)          | 28 699 970-47 |
|  | Brushed Chrome                 | 28 699 970-93 |
|  | Brushed Dark Platinum          | 28 699 970-99 |

## Recommended miscellaneous

### Concealed wall elbow -

35 085 970 90



- max. recess depth 163 mm
- min. recess depth 90 mm

28 699 970 Product version from 3/13/2017

mm [inches]



**Flow rate chart**



**Codes & Standards**

|                             |           |          |                        |
|-----------------------------|-----------|----------|------------------------|
| DIN 4109                    | EN 1112   | ISO 3822 | Scottish Water Byelaws |
| UK Water Supply Regulations | Ü-Zeichen |          |                        |



Rain shower with ceiling fixing 400 mm - Platinum

SERIES SPECIFIC

28 699 970 Product version from 3/13/2017

Certificates and sustainability

|        |           |                 |
|--------|-----------|-----------------|
| LGA_29 | WRAS_2212 | DVGW_DW-6517DN0 |
|--------|-----------|-----------------|

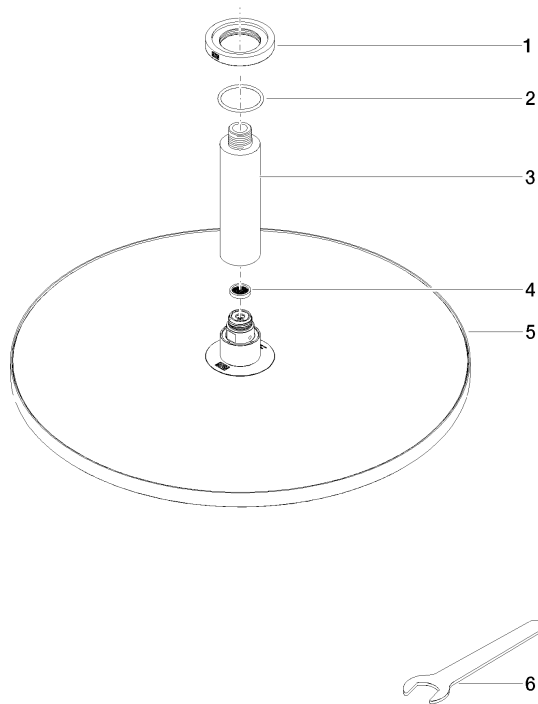

**Spare parts list**

| No. | Item Number        | Name       | Quantity used | Delivery time |
|-----|--------------------|------------|---------------|---------------|
| 2   | 09 14 10 141 90    | seal       | 1.00          | 2             |
| 4   | 09 23 01 075 90    | insert     | 1.00          | 2             |
| 1   | 09 27 22 040-08    | rosette    | 1.00          | 40            |
| 3   | 09 11 03 080-08    | connection | 1.00          | 40            |
| 6   | 90 30 09 069 00 90 | key        | 1.00          | 2             |
| 5   | 90 12 05 090 00-08 | shower     | 1.00          | 40            |