







**CL.1 Wall valve clockwise closing cold 1/2" - Brushed Platinum**

36 617 706 Product version from 10/14/2020



- with WAVES structure
- rosette 60 x 60 mm
- with cold marking
- head part with cut-to-length spindle and sleeve
- WRAS

	Brushed Platinum	36 617 706-06
	Chrome	36 617 706-00
	Dark Chrome	36 617 706-19
	Brushed Champagne (22kt Gold)	36 617 706-46
	Champagne (22kt Gold)	36 617 706-47
	Brushed Dark Platinum	36 617 706-99

**Required miscellaneous**



**Wall valve 1/2" -** 35 607 970 90  
 •max. recess depth mm  
 •min. recess depth mm



## CL.1 Wall valve clockwise closing cold 1/2" - Brushed Platinum

---

36 617 706 Product version from 10/14/2020

mm [inches]



### Codes & Standards

---

ASME A112.18.1	cUPC	DIN 4109	EN 200
ISO 3822	Scottish Water Byelaws	UK Water Supply Regulations	Ü-Zeichen

### Certificates

---

DVGW_DW-6501DN0	LGA_29	WRAS_2010	LGA_29	IAPMO_4976 (
-----------------	--------	-----------	--------	--------------

**CL.1 Wall valve clockwise closing cold 1/2" - Brushed Platinum**

36 617 706 Product version from 10/14/2020

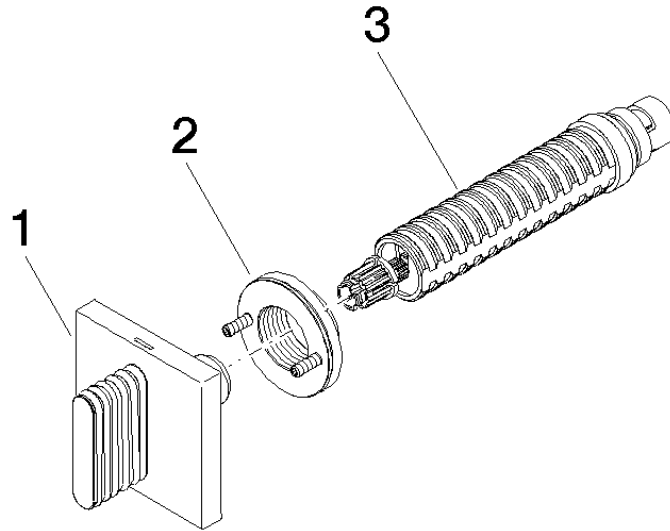

**Spare parts list**

No.	Item Number	Name	Quantity used	Delivery time
1	90 20 70 055 02-06	handle ( cold )	1	10
2	90 21 02 108 00 90	disc	1	2
3	90 90 03 143 00 90	top	1	2