

MEM Bath cascade spout for wall mounting - Chrome

13 430 730

- 220mm projection
- cascade
- plate 78 mm x 192 mm
- 1/2" connection
- plug-link mounting
- max. flow 26.5 l/min at 3 bar flow pressure



Recommended miscellaneous



- Concealed wall elbow -

•max. recess depth mm

•min. recess depth mm

35 085 970 90

MEM Bath cascade spout for wall mounting - Chrome

13 430 730

mm [inches]

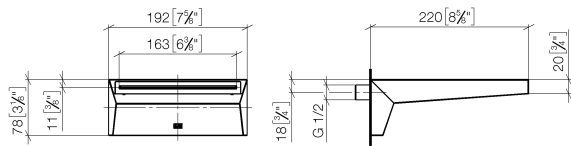

Flow rate chart

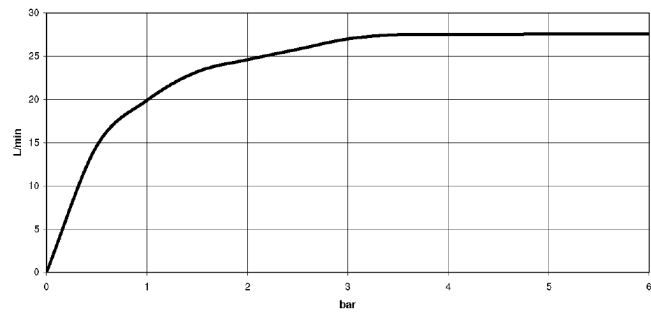

Trajectory diagram

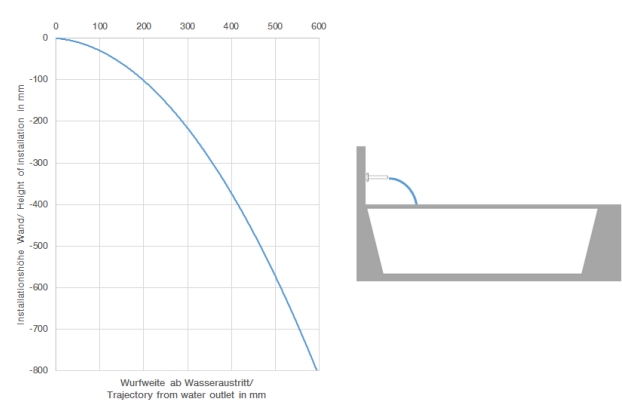

Codes & Standards

ASME A112.18.1	cUPC	DIN 4109	ISO 3822
----------------	------	----------	----------

Ü-Zeichen



MEM Bath cascade spout for wall mounting - Chrome

13 430 730

Certificates

IAPMO_4976

LGA_19

MEM Bath cascade spout for wall mounting - Chrome

13 430 730

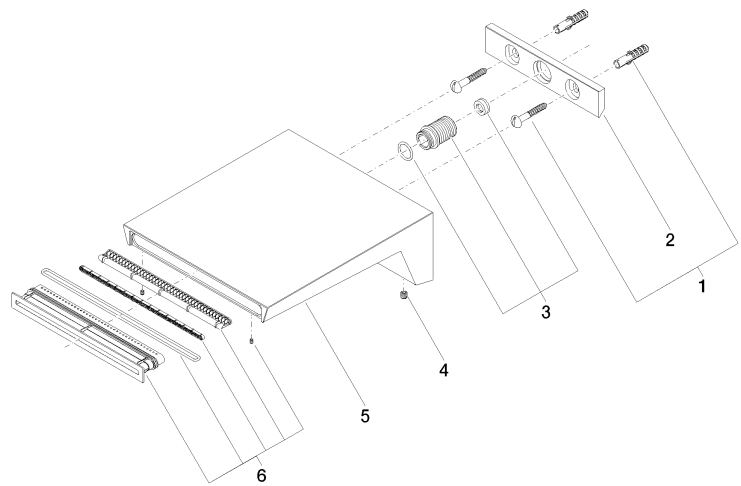

Spare parts list

No.	Item Number	Name	Quantity used	Delivery time
1	04 30 31 024 01 90	fixing set	1	2
2	09 17 97 056 90	holder	1	2
3	90 24 05 008 00 90	nipple set	1	2
4	09 31 11 049 90	pin	2	2
5	09 11 73 002-00	spout	1	60
6	90 29 03 059 00 90	insert	1	2
9	09 14 10 199 90	seal	1	2