

20 000 985 Product version from 4/30/2013

- hole diameter valve 32 mm
- rosette 60 x 60 mm
- with hot marking



20 000 985 Product version from 4/30/2013

mm [inches]

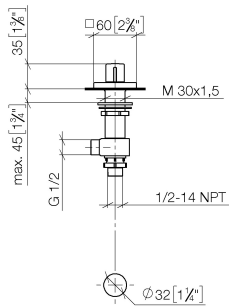

Flow rate chart

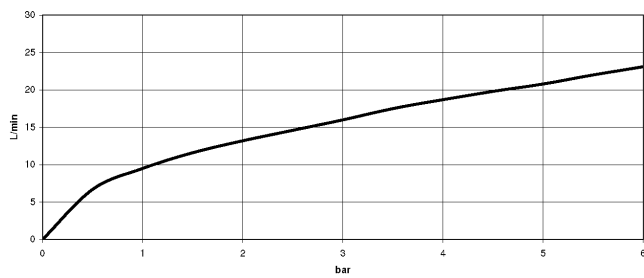

Codes & Standards

ASME A112.18.1

cUPC

EN 200

NSF372

VA-Zeichen



SYMETRICS Deck valve anti-clockwise closing hot - Brushed Platinum

SYMETRICS

20 000 985 Product version from 4/30/2013

Certificates and sustainability

ETA_18

IAPMO_4976

IAPMO_6

