

CL.1 Deck valve anti-clockwise closing hot - Champagne (22kt Gold)

CL.1

20 005 706    Product version from 3/9/2015



- with WAVES structure
- hole diameter 32 mm
- rosette 60 x 47 mm
- with hot marking
- WRAS

|   |                               |               |
|---|-------------------------------|---------------|
|  | Champagne (22kt Gold)         | 20 005 706-47 |
|  | Chrome                        | 20 005 706-00 |
|  | Brushed Platinum              | 20 005 706-06 |
|  | Dark Chrome                   | 20 005 706-19 |
|  | Brushed Champagne (22kt Gold) | 20 005 706-46 |
|  | Brushed Dark Platinum         | 20 005 706-99 |

20 005 706 Product version from 3/9/2015

mm [inches]

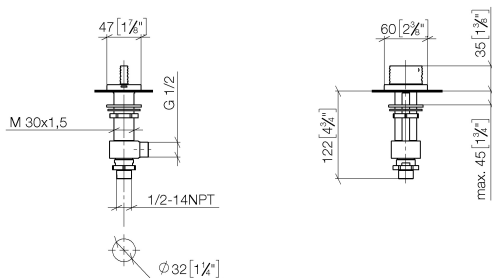

## Flow rate chart



## Codes & Standards

DIN 4109

ISO 3822

NSF372

NSF61

Scottish Water  
Byelaws

UK Water Supply  
Regulations

Ü-Zeichen



CL.1 Deck valve anti-clockwise closing hot - Champagne (22kt Gold)

CL.1

20 005 706 Product version from 3/9/2015

Certificates and sustainability

|           |        |         |             |
|-----------|--------|---------|-------------|
| IAPMO_N-4 | LGA_28 | IAPMO_6 | WRAS_240202 |
|-----------|--------|---------|-------------|

20 005 706 Product version from 3/9/2015

Parts for other  
finishes can be found  
here: [Chrome](#)



## Spare parts list

| No. | Item Number        | Name               | Quantity used | Delivery time |
|-----|--------------------|--------------------|---------------|---------------|
| 4   | 04 23 10 032 78 90 | fixing set         | 1.00          | 2             |
| 7   | 09 30 11 059 90    | disc               | 1.00          | 2             |
| 6   | 90 23 30 040 00-47 | threaded connector | 1.00          | 30            |
| 2   | 04 17 11 058 52 90 | side panel         | 1.00          | 2             |
| 3   | 90 90 03 152 00 90 | top                | 1.00          | 2             |
| 8   | 09 23 10 012 90    | nut                | 1.00          | 2             |
| 1   | 90 20 70 055 07-47 | handle ( hot )     | 1.00          | 30            |
| 5   | 04 17 11 023 10 90 | distributor        | 1.00          | 2             |