

## MEM Bath shower set for bath rim or tile edge installation - Dark Chrome

MEM

27 532 782



- 220mm projection
- spout: rectangular normal flow
- max. flow 27.3 l/min at 3 bar flow pressure
- Hand shower: COMPACT RAIN, max. flow rate 6.8 l/min (at 3 bar)
- complete hand shower set with anti-scale system
- automatic bath/shower diverter
- height of mixer 300 mm
- height up to aerator 170 mm
- hole diameter valve 32 mm
- hole diameter spout 32 mm
- hole diameter for complete hand shower set 32 mm
- rosette for spout 60 x 60mm
- rosette for complete hand shower set 60 x 60mm
- rosette for deck valve 60 x 60mm
- metal shower hose 1750mm with integrated anti-twist protection
- WRAS 2306058

Intrinsic protection against back flow.

|  |                                |               |
|--|--------------------------------|---------------|
|  | Dark Chrome                    | 27 532 782-19 |
|  | Chrome                         | 27 532 782-00 |
|  | Brushed Platinum               | 27 532 782-06 |
|  | Platinum                       | 27 532 782-08 |
|  | Brushed Durabronze (23kt Gold) | 27 532 782-28 |
|  | Brushed Champagne (22kt Gold)  | 27 532 782-46 |
|  | Champagne (22kt Gold)          | 27 532 782-47 |
|  | Brushed Dark Platinum          | 27 532 782-99 |

### Recommended miscellaneous



**Perfecto installation kit -**

12 614 970 90

### Recommended miscellaneous



**Decorative caps for Perfecto - Dark Chrome**

- 1 pair

12 801 970-19





## MEM Bath shower set for bath rim or tile edge installation - Dark Chrome

---

MEM

27 532 782

### Certificates

---

WRAS\_2306

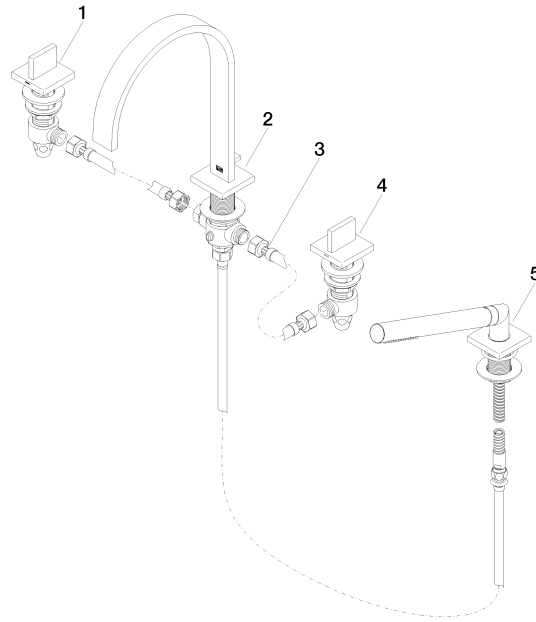



## MEM Bath shower set for bath rim or tile edge installation - Dark Chrome

---

MEM

27 532 782

### **Spare parts list**