

LISSÉ Hand shower set with individual rosettes - Dark Chrome

LISSÉ

27 803 845 Product version from 6/3/2020



- Three or five settings: COMPACT RAIN, COMPACT SOFT FLOW, COMPACT AQUAPRESSURE FLOW, max. flow rate 15 l/min (at 3 bar)
- metal shower hose 1250mm with integrated anti-twist protection
- 3/8" shower outlet
- with anti-scale system









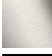
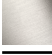

Technical data:

- rosette for wall elbow 60 x 78mm
- rosette for shower holder 60 x 78mm
- 1/2" wall elbow

Notes:

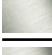
- WRAS

Intrinsic protection against back flow.

| | | |
|---|-----------------------|--------------------|
|  | Dark Chrome | 27 803 845-19 |
|  | Chrome | 27 803 845-00 |
|  | Chrome | 27 803 845-00 0010 |
|  | Brushed Platinum | 27 803 845-06 |
|  | Brushed Platinum | 27 803 845-06 0010 |
|  | Dark Chrome | 27 803 845-19 0010 |
|  | Brushed Light Gold | 27 803 845-27 |
|  | Brushed Light Gold | 27 803 845-27 0010 |
|  | Matte Black | 27 803 845-33 0010 |
|  | Matte Black | 27 803 845-33 |
|  | Brushed Chrome | 27 803 845-93 |
|  | Brushed Chrome | 27 803 845-93 0010 |
|  | Brushed Dark Platinum | 27 803 845-99 |
|  | Brushed Dark Platinum | 27 803 845-99 0010 |

Recommended miscellaneous

Concealed wall elbow -

35 085 970 90

- max. recess depth 163 mm
- min. recess depth 90 mm



27 803 845 Product version from 6/3/2020

mm [inches]

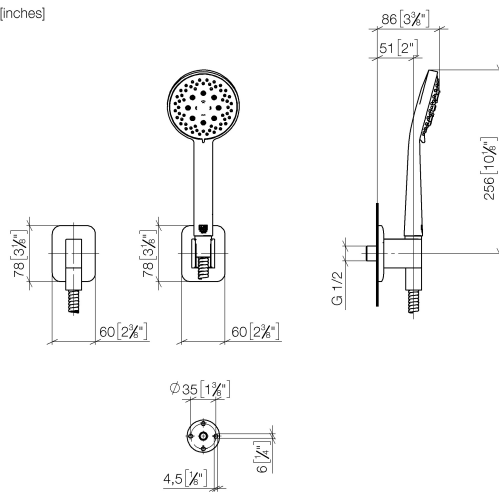

Flow rate chart



Codes & Standards

DIN 4109

ISO 3822

Scottish Water
Byelaws

UK Water Supply
Regulations

Ü-Zeichen



LISSE Hand shower set with individual rosettes - Dark Chrome

LISSE

27 803 845 Product version from 6/3/2020

Certificates and sustainability

| | | |
|--------|--------|-----------|
| LGA_29 | LGA_29 | WRAS_2304 |
|--------|--------|-----------|

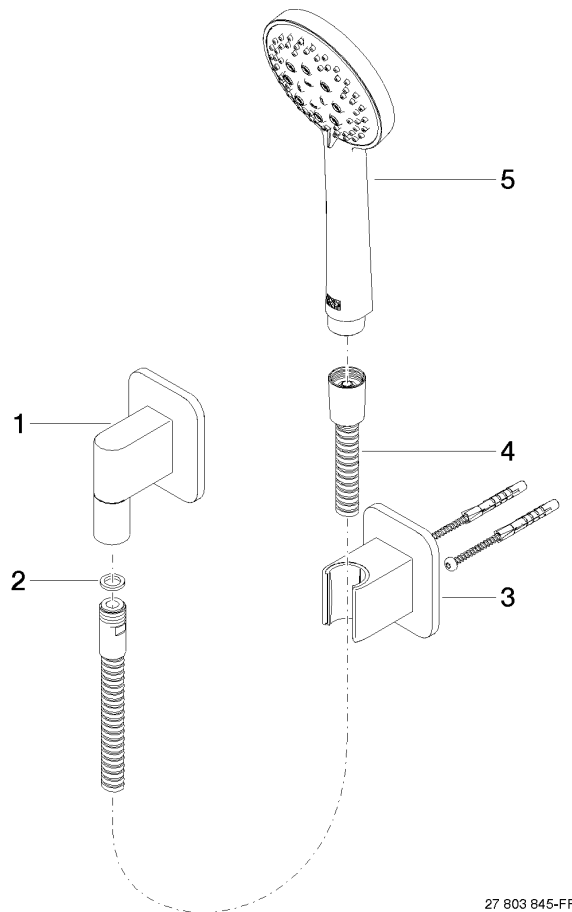

27 803 845-FF

Spare parts list

| No. | Item Number | Name | Quantity used | Delivery time |
|-----|--------------------|---|---------------|---------------|
| 4 | 90 30 02 072 00-19 | Metal shower hose 1/2" x 3/8" x 1250 mm - Dark Chrome | 1.00 | 20 |
| 1 | 28 450 845-19 | LISSÉ Wall elbow - Dark Chrome | 1.00 | 20 |
| 2 | 90 14 20 026 00 90 | seal | 1.00 | 2 |
| 3 | 28 050 845-19 | LISSÉ Wall bracket - Dark Chrome | 1.00 | 20 |
| 5 | 90 12 11 173 00-19 | shower | 1.00 | 20 |