

LISSÉ Hand shower set with individual rosettes FlowReduce - Matte Black

LISSÉ

27 803 845 Product version from 4/1/2024



- Three or five settings: COMPACT RAIN, COMPACT SOFT FLOW, COMPACT AQUAPRESSURE FLOW, max. flow rate 6.8 l/min (at 3 bar)
- metal shower hose 1250mm with integrated anti-twist protection
- 3/8" shower outlet
- with anti-scale system











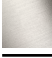

Technical data:

- rosette for wall elbow 60 x 78mm
- rosette for shower holder 60 x 78mm
- 1/2" wall elbow

Notes:

- WRAS

Intrinsic protection against back flow.

	Matte Black	27 803 845-33 0010
	Chrome	27 803 845-00
	Chrome	27 803 845-00 0010
	Brushed Platinum	27 803 845-06
	Brushed Platinum	27 803 845-06 0010
	Dark Chrome	27 803 845-19 0010
	Dark Chrome	27 803 845-19
	Brushed Light Gold	27 803 845-27
	Brushed Light Gold	27 803 845-27 0010
	Matte Black	27 803 845-33
	Brushed Chrome	27 803 845-93
	Brushed Chrome	27 803 845-93 0010
	Brushed Dark Platinum	27 803 845-99
	Brushed Dark Platinum	27 803 845-99 0010

Recommended miscellaneous

Concealed wall elbow -

35 085 970 90



- max. recess depth 163 mm
- min. recess depth 90 mm

mm [inches]

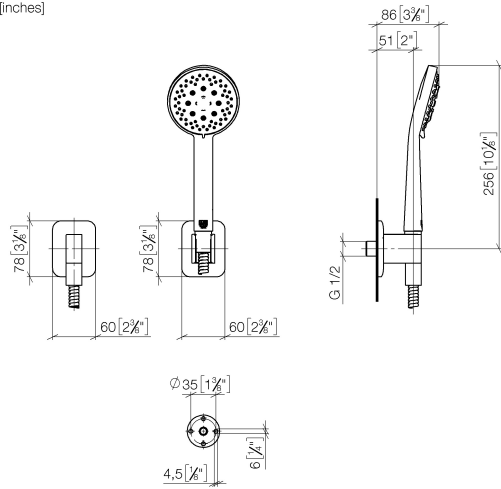

Codes & Standards

ASME A112.18.1	cUPC	DIN 4109	ISO 3822

Ü-Zeichen

Certificates and sustainability

LGA_29	IAPMO_4976 (

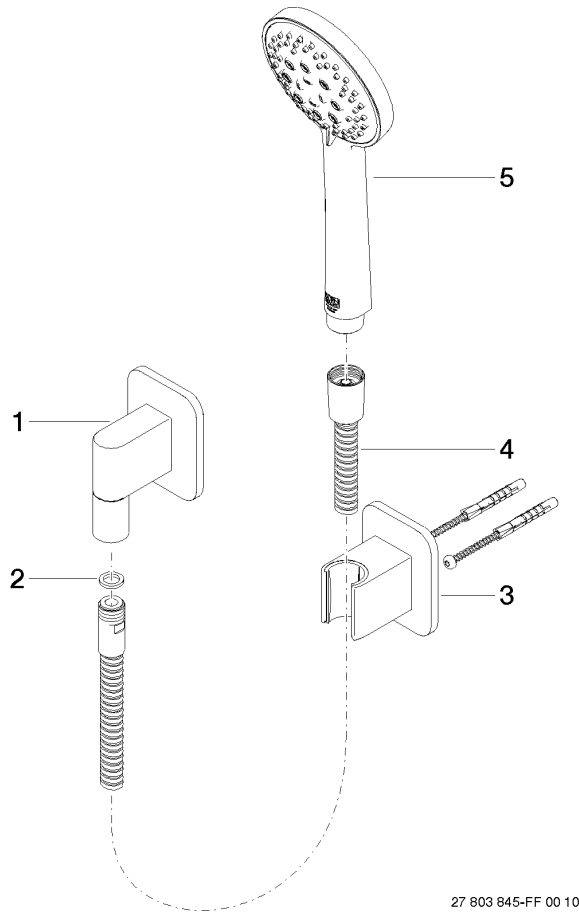

27 803 845-FF 00 10

Spare parts list

No.	Item Number	Name	Quantity used	Delivery time
1	28 450 845-33	LISSÉ Wall elbow - Matte Black	1.00	30
3	28 050 845-33	LISSÉ Wall bracket - Matte Black	1.00	30
5	28 014 979-33 0010	Hand shower - Matte Black	1.00	-
Spare part can no longer be ordered, please order the replacement item				
28018979-330010		Hand shower FlowReduce - Matte Black		
4	90 30 02 072 00-33	Metal shower hose 1/2" x 3/8" x 1250 mm - Matte Black	1.00	30
2	90 14 20 026 00 90	seal	1.00	2