

LULU Hand shower set with individual rosettes - Chrome

LULU

27 808 710

Product version up to 6/3/2020



- COMPACT RAIN, max. flow rate 15 l/min (at 3 bar)
- 3/8" shower outlet
- with anti-scale system
- metal shower hose 1250mm with integrated anti-twist protection



Technical data:

- rosette for wall elbow 78 x 55mm
- rosette for shower holder 78 x 55mm
- 1/2" wall elbow

Notes:

- WRAS

Intrinsic protection against back flow.

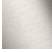
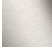
|   |                  |                    |
|---|------------------|--------------------|
|  | Chrome           | 27 808 710-00      |
|  | Chrome           | 27 808 710-00 0010 |
|  | Brushed Platinum | 27 808 710-06      |
|  | Brushed Platinum | 27 808 710-06 0010 |

Recommended miscellaneous



- Concealed wall elbow -

35 085 970 90

  - max. recess depth 163 mm
  - min. recess depth 90 mm

## LULU Hand shower set with individual rosettes - Chrome

LULU

27 808 710 Product version up to 6/3/2020

mm [inches]

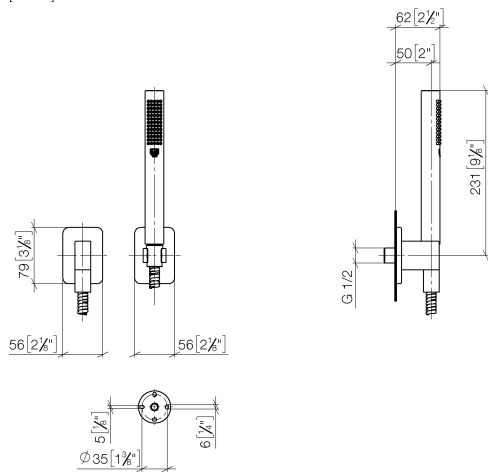

### Flow rate chart



### Codes & Standards

DIN 4109

EN 1717

ISO 3822

Scottish Water  
Byelaws

UK Water Supply  
Regulations

Ü-Zeichen



## LULU Hand shower set with individual rosettes - Chrome

---

LULU

27 808 710 Product version up to 6/3/2020

### Certificates and sustainability

---

LGA\_29

Belgaqua\_21-383-2 WRAS\_2209

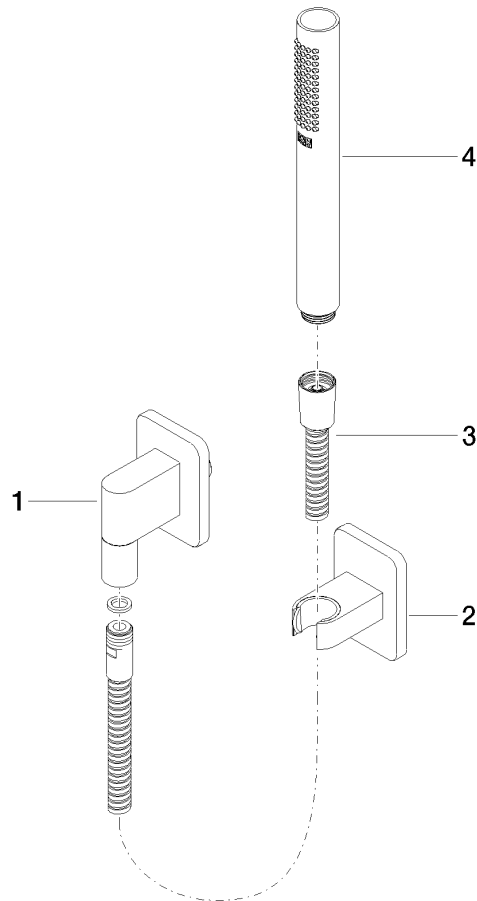

## Spare parts list

| No.  | Item Number        | Name   | Quantity used | Delivery time |
|--|--------------------|--|---------------|---------------|
| 3  | 90 30 02 072 00-00 | Metal shower hose 1/2" x 3/8" x 1250 mm - Chrome | 1.00          | 10            |
| 2  | 28 050 710-00      | LULU Wall bracket - Chrome                       | 1.00          | -             |
| Spare part can no longer be ordered, please order the replacement item |                    |  |               |               |
| 1  | 28 450 710-00      | LULU Wall elbow - Chrome                         | 1.00          | 10            |
| 4  | 90 12 11 140 40-00 | shower   | 1.00          | 10            |