

Hand shower set with individual rosettes with volume control - Chrome

SERIES SPECIFIC

27 809 980
Product version up to 6/3/2020



- COMPACT RAIN, max. flow rate 15 l/min (at 3 bar)
- with volume control
- with anti-scale system
- 3/8" shower outlet
- rosette for wall elbow 60 x 60mm
- rosette for shower holder 60 x 60mm
- metal shower hose 1250mm with integrated anti-twist protection
- 1/2" wall elbow
- WRAS

Intrinsic protection against back flow.

Recommended miscellaneous



- Concealed wall elbow -**

35 085 970 90
- max. recess depth 163 mm
 - min. recess depth 90 mm

27 809 980 Product version up to 6/3/2020

mm [inches]

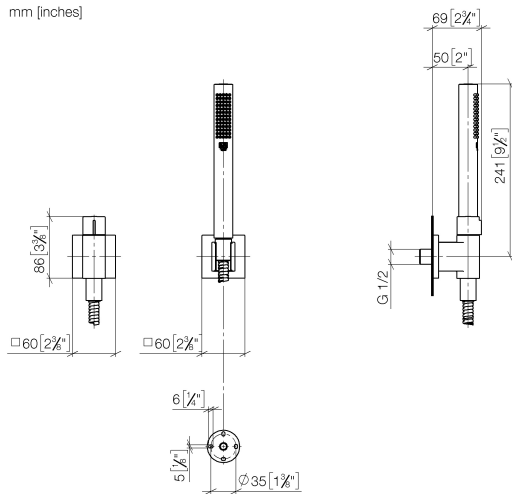

Flow rate chart



Codes & Standards

DIN 4109

EN 1717

ISO 3822

Scottish Water
Byelaws

UK Water Supply
Regulations

Ü-Zeichen



Hand shower set with individual rosettes with volume control - Chrome

SERIES SPECIFIC

27 809 980 Product version up to 6/3/2020

Certificates and sustainability

WRAS_2207

LGA_29

Belgaqua_22_280_2

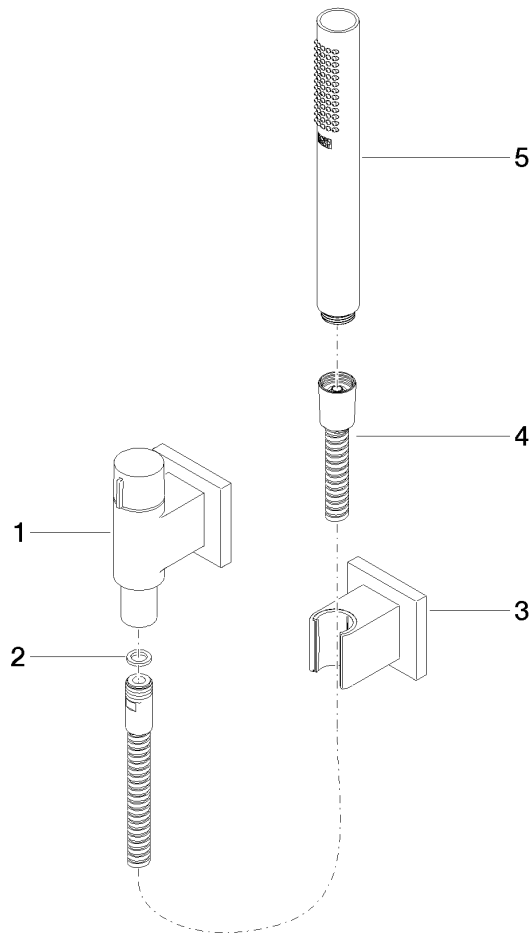

Spare parts list

No.	Item Number	Name	Quantity used	Delivery time
3	28 050 980-00	Wall bracket - Chrome	1.00	10
1	28 451 980-00	connection	1.00	60
4	90 30 02 072 00-00	Metal shower hose 1/2" x 3/8" x 1250 mm - Chrome	1.00	10
2	90 14 20 026 00 90	seal	1.00	2
5	90 12 11 140 40-00	shower	1.00	10