

Shower head - Champagne (22kt Gold)

TARA

28 504 979



- 180-210mm projection
- ball-joint pivotable through 30°
- PURIFY RAIN, max. flow rate 7 l/min (at 3 bar)
- Function from: 6 l/min
- with anti-scale system
- spray head Ø 100mm
- rosette Ø 55 mm
- 1/2" connection

Fits: TARA, LISSÉ, VAIA, META

| | | |
|--|--------------------------------|---------------|
| | Champagne (22kt Gold) | 28 504 979-47 |
| | Chrome | 28 504 979-00 |
| | Brushed Platinum | 28 504 979-06 |
| | Platinum | 28 504 979-08 |
| | Dark Chrome | 28 504 979-19 |
| | Light Gold | 28 504 979-26 |
| | Brushed Light Gold | 28 504 979-27 |
| | Brushed Durabronze (23kt Gold) | 28 504 979-28 |
| | Matte Black | 28 504 979-33 |
| | Brushed Bronze | 28 504 979-42 |
| | Brushed Champagne (22kt Gold) | 28 504 979-46 |
| | Brushed Chrome | 28 504 979-93 |
| | Brushed Dark Platinum | 28 504 979-99 |

Recommended miscellaneous



Concealed wall elbow -

35 085 970 90

- max. recess depth 163 mm
- min. recess depth 90 mm

Shower head - Champagne (22kt Gold)

TARA

28 504 979

mm [inches]



Flow rate chart



Codes & Standards

DIN 4109

EN 1112

ISO 3822

Ü-Zeichen



Shower head - Champagne (22kt Gold)

TARA

28 504 979

Certificates

DVGW_DW-
6517DN0

LGA_19

Product version from 4/1/2024

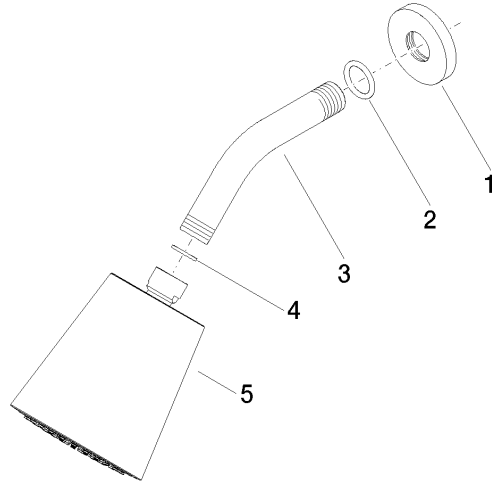



Shower head - Champagne (22kt Gold)

TARA

28 504 979

Spare parts list

Product version from 4/1/2024

| No. | Item Number | Name | Quantity used | Delivery time |
|-----|-----------------|---------|---------------|---------------|
| | 09 27 22 003-47 | rosette | 5 | 60 |