







MADISON Rain shower with wall fixing FlowReduce 200 mm - Chrome

MADISON

28 544 977



- 435mm projection
- rain shower Ø 200 mm
- rain flow
- max. flow 7 l/min
- Function from: 6.5 l/min
- rosette Ø 55 mm
- 1/2" connection
- with anti-scale system
- This product can help a building meet the requirements of Green Building Rating Systems, e.g. LEED®, BREEAM®, DGNB

| | | |
|---|-------------------------------|---------------|
|  | Chrome | 28 544 977-00 |
|  | Brushed Platinum | 28 544 977-06 |
|  | Platinum | 28 544 977-08 |
|  | Durabrass (23kt Gold) | 28 544 977-09 |
|  | Brushed Durabrass (23kt Gold) | 28 544 977-28 |
|  | Brushed Dark Platinum | 28 544 977-99 |

28 544 977

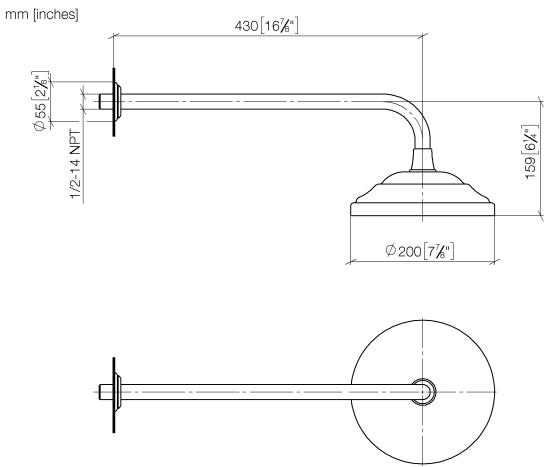

Flow rate chart

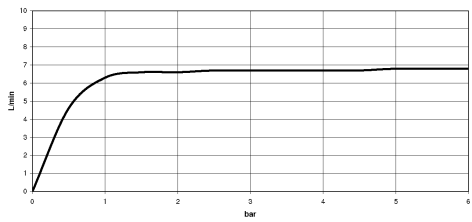

Codes & Standards

DIN 4109

ISO 3822

Scottish Water
Byelaws

UK Water Supply
Regulations

Ü-Zeichen



MADISON Rain shower with wall fixing FlowReduce 200 mm - Chrome

MADISON

28 544 977

Certificates and sustainability

LGA_38

WRAS_250102

28 544 977

Parts for other
finishes can be found
here: Brushed
Platinum

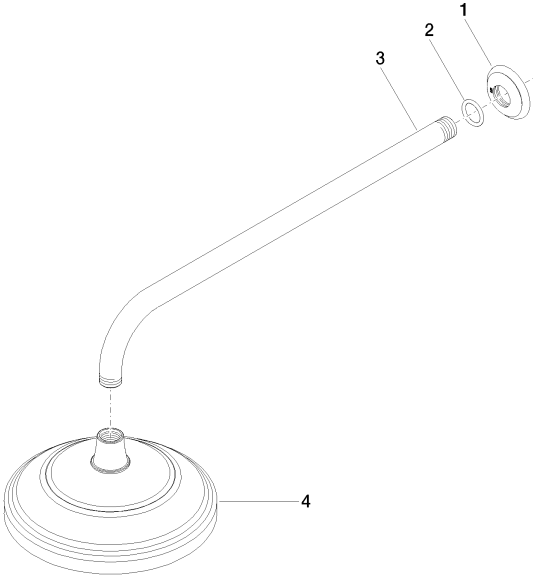

Spare parts list

| No. | Item Number | Name | Quantity used | Delivery time |
|-----|----------------------|------------|---------------|---------------|
| | 3 09 11 03 017-00 | connection | 1.00 | 10 |
| | 4 90 12 05 038 20-00 | shower | 1.00 | 10 |
| | 1 09 27 35 003-00 | rosette | 1.00 | 10 |
| | 2 90 14 10 026 00 90 | seal | 1.00 | 2 |