







MADISON Rain shower with wall fixing 200 mm - Brushed Chrome
MADISON

28 545 977
Product version up to 12/5/2019

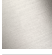
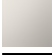

- 435mm projection
- rain shower Ø 200 mm
- PURE RAIN, max. flow rate 14 l/min (at 3 bar)
- Function from: 8 l/min
- rosette Ø 55 mm
- 1/2" connection
- with anti-scale system

	Brushed Chrome	28 545 977-93
	Chrome	28 545 977-00
	Brushed Platinum	28 545 977-06
	Platinum	28 545 977-08
	Durabrass (23kt Gold)	28 545 977-09
	Brushed Durabrass (23kt Gold)	28 545 977-28
	Brushed Dark Platinum	28 545 977-99

28 545 977 Product version up to 12/5/2019

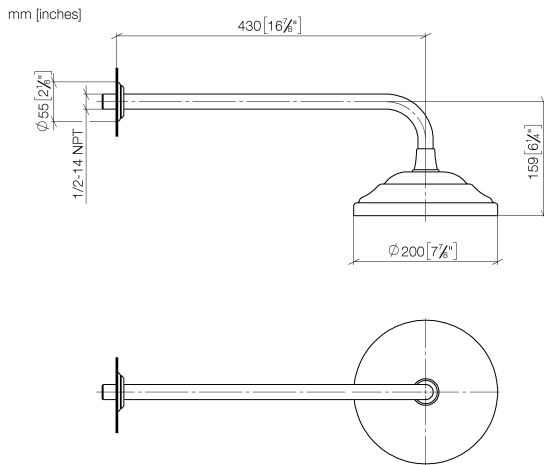

Flow rate chart

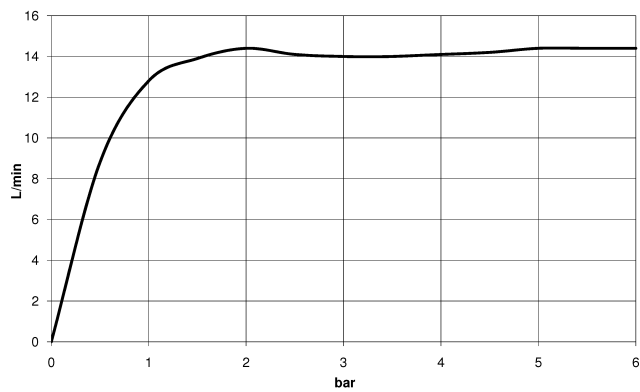

Codes & Standards

ASME A112.18.1	cUPC	DIN 4109	EN 1112
ISO 3822	Scottish Water Byelaws	UK Water Supply Regulations	Ü-Zeichen



MADISON Rain shower with wall fixing 200 mm - Brushed Chrome

MADISON

28 545 977    Product version up to 12/5/2019

Certificates and sustainability

DVGW_DW- 6517DN0	LGA_38	IAPMO_4976	WRAS_250102
---------------------	--------	------------	-------------

28 545 977 Product version up to 12/5/2019

Parts for other  
finishes can be found  
here: [Chrome](#)

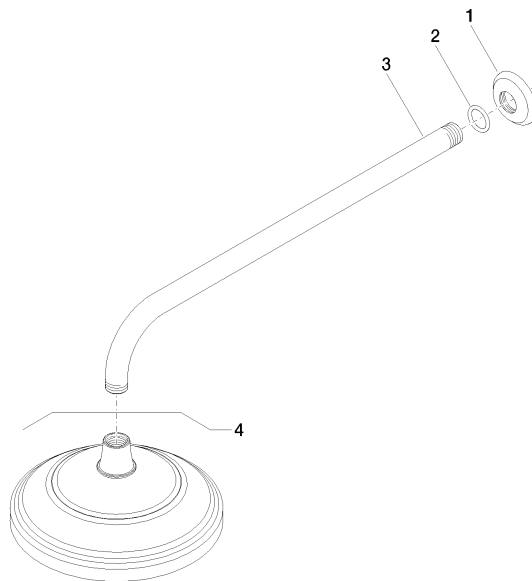

## Spare parts list

No.	Item Number	Name	Quantity used	Delivery time
1	09 27 35 003-93	rosette	1.00	60
3	09 11 03 017-93	connection	1.00	60
4	28 535 977-93	shower	1.00	-
Spare part can no longer be ordered, please order the replacement item				
2	90 14 10 026 00 90	seal	1.00	2