

33 818 875 Product version from 5/31/2010 to 7/25/2018



- 281mm projection
- pivotable spout 360°
- air-enriched flow
- height of mixer 422 mm
- height up to aerator 240 mm
- hole diameter 35 mm
- max. flow 8 l/min at 3 bar flow pressure
- lead-free
- This product can help a building meet the requirements of Green Building Rating Systems, e.g. LEED®, BREEAM®, DGNB
- WRAS

Recommended miscellaneous

<hr/>		
	Dispenser without rosette - Chrome	82 424 970-00

Recommended miscellaneous

<hr/>		
	Strainer waste with control handle - Chrome	10 712 970-00

33 818 875 Product version from 5/31/2010 to 7/25/2018

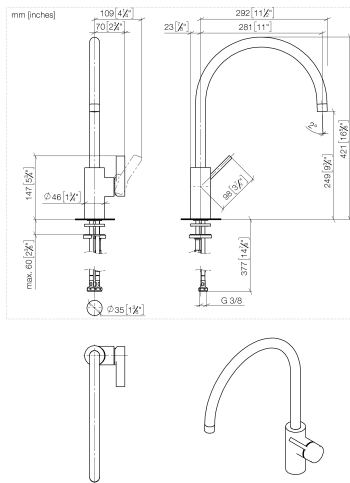

Flow rate chart



Codes & Standards

EN 817

Executive Order
no. 1007

Scottish Water
Byelaws

UK Water Supply
Regulations

VA-Zeichen



TARA ULTRA Single-lever mixer - Chrome

TARA ULTRA

33 818 875 Product version from 5/31/2010 to 7/25/2018

Certificates and sustainability

GDV_0400 WRAS_2101 ETA_18

33 818 875 Product version from 5/31/2010 to 7/25/2018

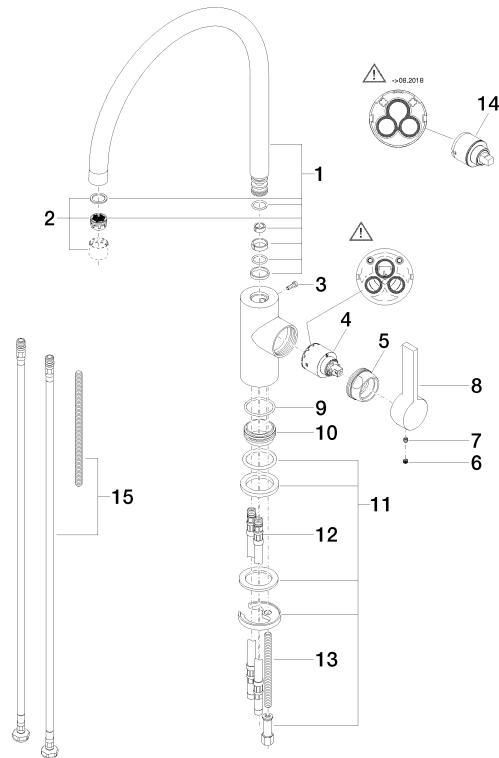

Spare parts list

No.	Item Number	Name	Quantity used	Delivery time
10	09 28 10 109-07	ring	1.00	30
11	04 30 11 085 88 90	fixing set	1.00	2
12	04 30 04 016 00 90	hose	2.00	60
8	09 20 79 040-00	handle	1.00	10
3	09 30 30 080 90	screw	1.00	2
5	09 24 04 107-00	nut	1.00	10
2	90 23 01 004 07-00	aerator	1.00	10
15	12 803 970 90	extension	1.00	60
1	90 28 22 203 02-00	spout	1.00	10
9	09 14 10 119 90	seal	1.00	2
4	90 15 05 061 00 90	cartridge	1.00	60
13	09 31 11 012 90	pin	1.00	2
7	90 31 11 030 00 90	pin	1.00	2
6	90 31 20 109 00 90	plug	1.00	2
14	90 15 05 045 00 90	cartridge	1.00	2