

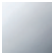







VAIA Single-lever mixer Pull-down with spray function - Brushed Dark Platinum
VAIA

33 870 809

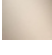

- 240mm projection
  - pivotable spout 360°
  - Optional swivel limiter available with swivel limiter set 12 823 970 90
  - air-enriched flow and spray flow
  - 1800 mm metal shower hose
  - sprayface with anti-scaling system
  - max. flow 8 l/min at 3 bar flow pressure
  - lead-free
  - This product can help a building meet the requirements of Green Building Rating Systems, e.g. LEED®, BREEAM®, DGNB
- Intrinsic protection against back flow.

|   |                               |               |
|---|-------------------------------|---------------|
|    | Brushed Dark Platinum         | 33 870 809-99 |
|    | Chrome                        | 33 870 809-00 |
|    | Brushed Platinum              | 33 870 809-06 |
|    | Platinum                      | 33 870 809-08 |
|    | Durabrass (23kt Gold)         | 33 870 809-09 |
|    | Dark Chrome                   | 33 870 809-19 |
|    | Brushed Durabrass (23kt Gold) | 33 870 809-28 |
|    | Matte Black                   | 33 870 809-33 |
|    | Brushed Champagne (22kt Gold) | 33 870 809-46 |
|   | Champagne (22kt Gold)         | 33 870 809-47 |
|  | Brushed Chrome                | 33 870 809-93 |

Recommended miscellaneous

|   |                         |               |
|---|-------------------------|---------------|
|  | Swivel limitation set - | 12 823 970 90 |
|---|-------------------------|---------------|

Recommended miscellaneous

|   |  |               |
|---|--|---------------|
|  | VAIA Dispenser with rosette -<br>Brushed Dark Platinum | 82 434 809-99 |
|---|--|---------------|

33 870 809

mm [inches]  
1:5

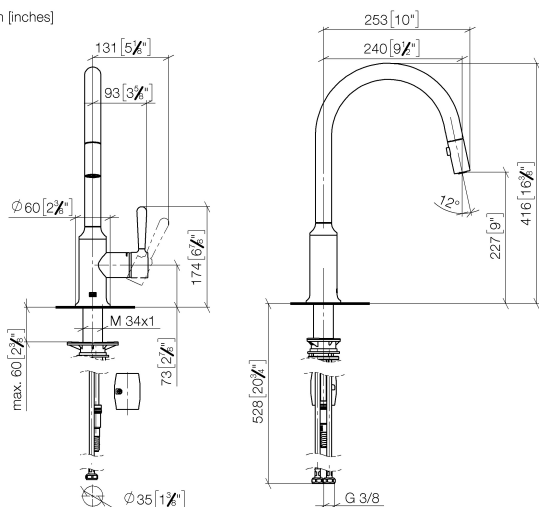

### Flow rate chart



### Certificates

LGA\_28657.

Belgaqua\_24-005-  
27\_3.

33 870 809

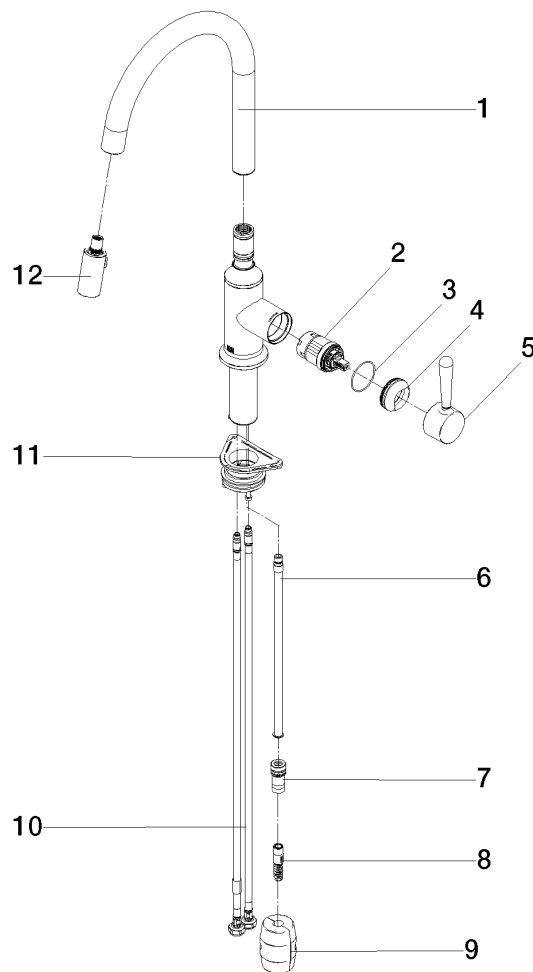

## Spare parts list

| No. | Item Number        | Name        | Quantity used | Delivery time |
|-----|--------------------|-------------|---------------|---------------|
| 1   | 90 28 22 397 00-99 | spout       | 1             | 30            |
| 2   | 90 15 05 064 05 90 | cartridge   | 1             | 2             |
| 3   | 09 14 10 190 90    | seal        | 1             | 2             |
| 4   | 09 28 30 030-99    | cover       | 1             | 30            |
| 5   | 90 20 80 052 00-99 | handle      | 1             | 30            |
| 6   | 04 28 20 067 00 90 | pipe        | 1             | 2             |
| 7   | 90 24 03 253 00 90 | adaptor     | 1             | 2             |
| 8   | 04 30 02 120 00-85 | hose        | 1             | 30            |
| 9   | 04 21 50 010 00 90 | accessories | 1             | 2             |
| 10  | 04 30 04 101 00 90 | hose        | 2             | 2             |
| 11  | 04 30 11 040 00 90 | fixing set  | 1             | 2             |
| 12  | 90 18 40 317 00-99 | shower      | 1             | 30            |