

META Concealed two-way diverter - Chrome

META

36 200 661



- rotary diverter
- without rosette
- handle Ø 60mm
- WRAS 2307045

	Chrome	36 200 661-00
	Brushed Platinum	36 200 661-06
	Dark Chrome	36 200 661-19
	Light Gold	36 200 661-26
	Brushed Light Gold	36 200 661-27
	Matte Black	36 200 661-33
	Brushed Bronze	36 200 661-42
	Brushed Champagne (22kt Gold)	36 200 661-46
	Champagne (22kt Gold)	36 200 661-47
	Brushed Chrome	36 200 661-93
	Brushed Dark Platinum	36 200 661-99

Required miscellaneous



Concealed two-way diverter -

35 202 970 90

- max. recess depth 160 mm
- min. recess depth 115 mm

36 200 661

mm [inches]

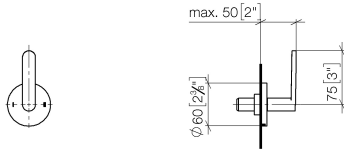

Flow rate chart



Codes & Standards

DIN 4109

ISO 3822

Scottish Water
Byelaws

UK Water Supply
Regulations

Ü-Zeichen



META Concealed two-way diverter - Chrome

META

36 200 661

Certificates

WRAS_2307

LGA_38

Product version from 4/1/2022

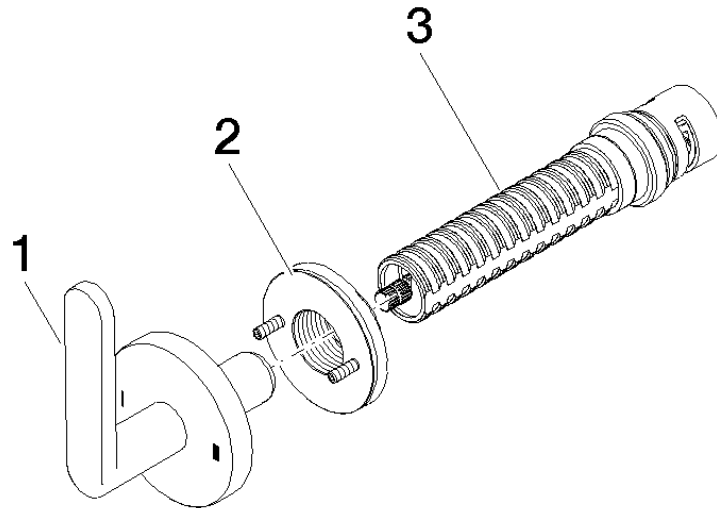



META Concealed two-way diverter - Chrome

META

36 200 661

Spare parts list

Product version from 4/1/2022

No.	Item Number	Name	Quantity used	Delivery time
	90 20 66 014 00-00	handle	3	10