

## META Concealed two-way diverter - Champagne (22kt Gold)

META

36 200 661



- rotary diverter
- without rosette
- handle Ø 60mm
- WRAS 2307045

|  |                               |               |
|--|-------------------------------|---------------|
|    | Champagne (22kt Gold)         | 36 200 661-47 |
|    | Chrome                        | 36 200 661-00 |
|    | Brushed Platinum              | 36 200 661-06 |
|    | Dark Chrome                   | 36 200 661-19 |
|    | Light Gold                    | 36 200 661-26 |
|    | Brushed Light Gold            | 36 200 661-27 |
|    | Matte Black                   | 36 200 661-33 |
|    | Brushed Bronze                | 36 200 661-42 |
|    | Brushed Champagne (22kt Gold) | 36 200 661-46 |
|   | Brushed Chrome                | 36 200 661-93 |
|  | Brushed Dark Platinum         | 36 200 661-99 |

36 200 661

mm [inches]

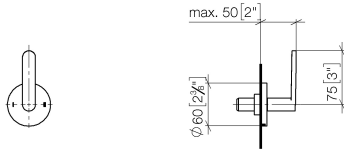

**Flow rate chart**



**Codes & Standards**

DIN 4109

ISO 3822

Scottish Water  
Byelaws

UK Water Supply  
Regulations

Ü-Zeichen



## META Concealed two-way diverter - Champagne (22kt Gold)

---

META

36 200 661

### Certificates

---

WRAS\_2307

LGA\_38

**Product version from 4/1/2022**

Parts for other  
finishes can be found  
here: [Chrome](#)

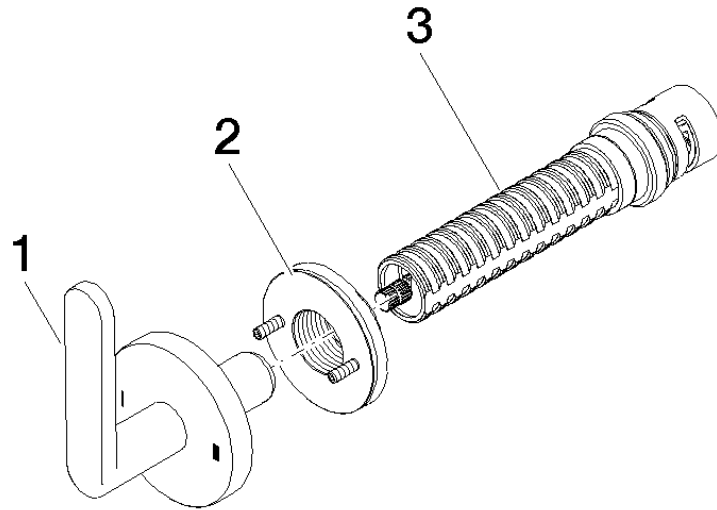



## META Concealed two-way diverter - Champagne (22kt Gold)

META

36 200 661

### Spare parts list

#### Product version from 4/1/2022

| No. | Item Number        | Name   | Quantity used | Delivery time |
|-----|--------------------|--------|---------------|---------------|
|     | 90 20 66 014 00-47 | handle | 3             | 30            |