

MEM Concealed two-way diverter - Dark Chrome

MEM

36 200 782



- rotary diverter
- rosette 60 x 60 mm
- WRAS 2307045

| | | |
|--|-------------------------------------|---------------|
|  | Dark Chrome | 36 200 782-19 |
|  | Chrome | 36 200 782-00 |
|  | Brushed Platinum | 36 200 782-06 |
|  | Platinum | 36 200 782-08 |
|  | Brushed Durabronze (23kt Gold) | 36 200 782-28 |
|  | Brushed Champagne (22kt Gold) | 36 200 782-46 |
|  | Champagne (22kt Gold) | 36 200 782-47 |
|  | Brushed Dark Platinum | 36 200 782-99 |

MEM Concealed two-way diverter - Dark Chrome

MEM

36 200 782

mm [inches]

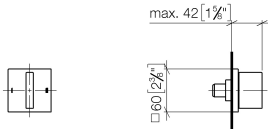

Flow rate chart



Codes & Standards

DIN 4109

ISO 3822

Scottish Water
Byelaws

UK Water Supply
Regulations

Ü-Zeichen



MEM Concealed two-way diverter - Dark Chrome

MEM

36 200 782

Certificates

WRAS_2307

LGA_38

36 200 782

Parts for other
finishes can be found
here: [Chrome](#)

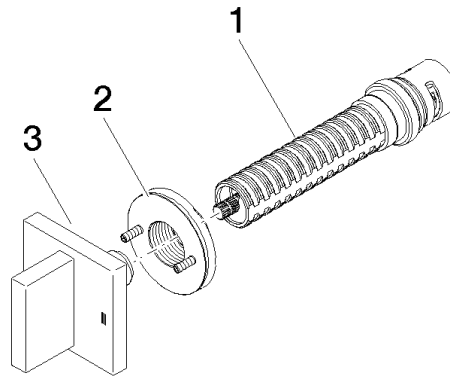



MEM Concealed two-way diverter - Dark Chrome

MEM

36 200 782

Spare parts list