





CL.1 Wall valve clockwise closing 1/2" - Chrome

CL.1

36 607 705

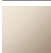

- rosette 60 x 60 mm
- without marking
- head part with cut-to-length spindle and sleeve

	Chrome	36 607 705-00
	Brushed Platinum	36 607 705-06
	Dark Chrome	36 607 705-19
	Brushed Champagne (22kt Gold)	36 607 705-46
	Champagne (22kt Gold)	36 607 705-47
	Brushed Dark Platinum	36 607 705-99

Required miscellaneous

	Wall valve 1/2" - •max. recess depth 150 mm •min. recess depth 105 mm	35 607 970 90
---	--	---------------

36 607 705

mm [inches]



Certificates

DVGW_DW-6501DN0116.	WRAS_2011026.	IAPMO_4976 (1).	LGA_29931.	WRAS_2010066.
DVGW_DW-6512DN0706.	LGA_29932.			

36 607 705

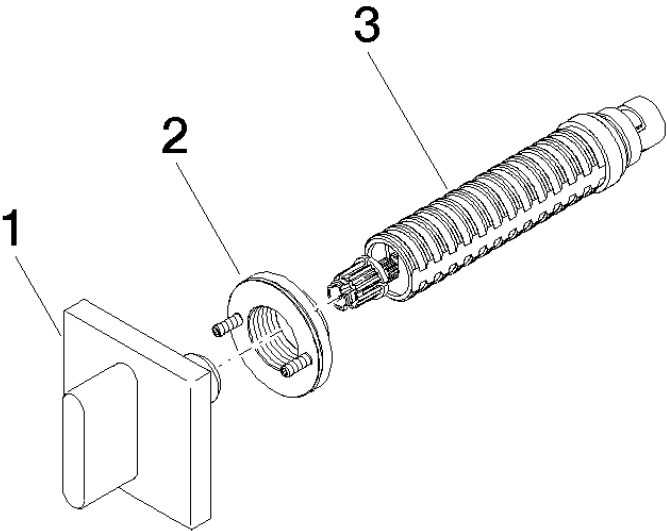

Spare parts list

No.	Item Number	Name	Quantity used	Delivery time
1	90 20 70 051 01-00	handle	1	10
2	90 21 02 108 00 90	disc	1	2
3	90 90 03 143 00 90	top	1	2