

## CYO Wall valve clockwise closing 1/2" - Brushed Platinum



CYO

36 607 811



- without rosette
- handle Ø 60mm
- head part with cut-to-length spindle and sleeve

NOTE: The handle inserts must be ordered separately from the fittings!

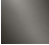
|  |   |               |
|--|---|---------------|
|  | Brushed Platinum                                  | 36 607 811-06 |
|  | Chrome  | 36 607 811-00 |
|  | Dark Chrome                                       | 36 607 811-19 |
|  | Brushed Durabronze<br>(23kt Gold)                 | 36 607 811-28 |
|  | Platinum / Brushed<br>Platinum                    | 36 607 811-36 |
|  | Durabronze /<br>Brushed Durabronze<br>(23kt Gold) | 36 607 811-38 |
|  | Brushed Bronze                                    | 36 607 811-42 |
|  | Brushed Dark<br>Platinum                          | 36 607 811-99 |



CYO Wall valve clockwise closing 1/2" - Brushed Platinum

CYO

36 607 811

mm [inches]



Codes & Standards

|                |      |          |          |
|----------------|------|----------|----------|
| ASME A112.18.1 | cUPC | DIN 4109 | ISO 3822 |
|----------------|------|----------|----------|

Ü-Zeichen

Certificates

|            |        |
|------------|--------|
| IAPMO_4976 | LGA_38 |
|------------|--------|

Parts for other  
finishes can be found  
here: [Chrome](#)

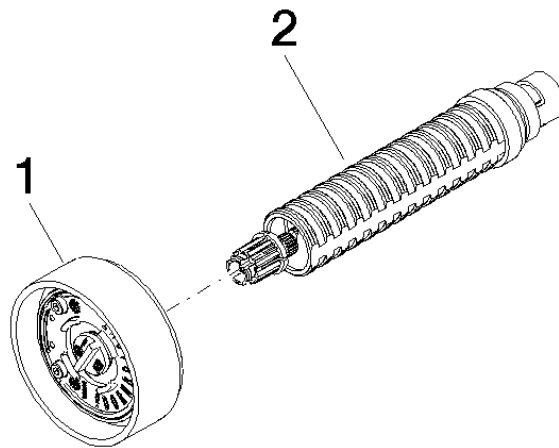



## CYO Wall valve clockwise closing 1/2" - Brushed Platinum

CYO

36 607 811

### Spare parts list

| No. | Item Number        | Name   | Quantity used | Delivery time |
|-----|--------------------|--------|---------------|---------------|
|     | 90 18 40 291 01-06 | handle | 2             | 10            |