







CL.1 Wall valve clockwise closing cold 1/2" - Dark Chrome

36 617 706 Product version from 10/14/2020



- with WAVES structure
- rosette 60 x 60 mm
- with cold marking
- head part with cut-to-length spindle and sleeve
- WRAS

	Dark Chrome	36 617 706-19
	Chrome	36 617 706-00
	Brushed Platinum	36 617 706-06
	Brushed Champagne (22kt Gold)	36 617 706-46
	Champagne (22kt Gold)	36 617 706-47
	Brushed Dark Platinum	36 617 706-99

Required miscellaneous

	<div> <div>Wall valve 1/2" -</div> <div> <div>•max. recess depth mm</div> <div>•min. recess depth mm</div> </div> </div>	35 607 970 90
--	--	---------------



CL.1 Wall valve clockwise closing cold 1/2" - Dark Chrome

36 617 706 Product version from 10/14/2020

mm [inches]



Codes & Standards

ASME A112.18.1	cUPC	DIN 4109	ISO 3822
Scottish Water Byelaws	UK Water Supply Regulations	Ü-Zeichen	

Certificates

LGA_29	WRAS_2010	IAPMO_4976 (
--------	-----------	--------------

CL.1 Wall valve clockwise closing cold 1/2" - Dark Chrome

36 617 706 Product version from 10/14/2020

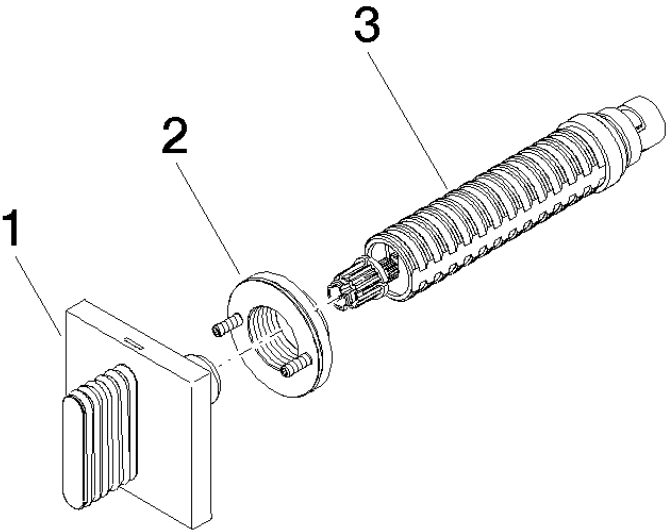

Spare parts list

No.	Item Number	Name	Quantity used	Delivery time
1	90 20 70 055 02-19	handle (cold)	1	20
2	90 21 02 108 00 90	disc	1	2
3	90 90 03 143 00 90	top	1	2