





CL.1 Wall valve clockwise closing cold 1/2" - Brushed Champagne (22kt Gold)

36 617 706 Product version from 10/14/2020

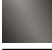

- with WAVES structure
- rosette 60 x 60 mm
- with cold marking
- head part with cut-to-length spindle and sleeve
- WRAS

	Brushed Champagne (22kt Gold)	36 617 706-46
	Chrome	36 617 706-00
	Brushed Platinum	36 617 706-06
	Dark Chrome	36 617 706-19
	Champagne (22kt Gold)	36 617 706-47
	Brushed Dark Platinum	36 617 706-99

Required miscellaneous



- Wall valve 1/2" -

•max. recess depth mm

•min. recess depth mm

35 607 970 90



CL.1 Wall valve clockwise closing cold 1/2" - Brushed Champagne (22kt Gold)

36 617 706 Product version from 10/14/2020

mm [inches]



Codes & Standards

ASME A112.18.1	cUPC	DIN 4109	ISO 3822
Scottish Water Byelaws	UK Water Supply Regulations	Ü-Zeichen	

Certificates

LGA_29	WRAS_2010	IAPMO_4976 (
--------	-----------	--------------

CL.1 Wall valve clockwise closing cold 1/2" - Brushed Champagne (22kt Gold)

36 617 706 Product version from 10/14/2020

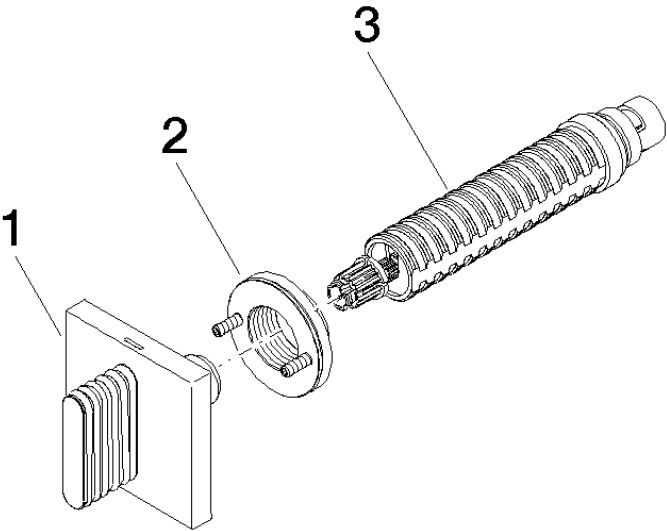

Spare parts list

No.	Item Number	Name	Quantity used	Delivery time
1	90 20 70 055 02-46	handle (cold)	1	30
2	90 21 02 108 00 90	disc	1	2
3	90 90 03 143 00 90	top	1	2